

AURA LIFTER ALUMINIUM

USER MANUAL



Congratulations and thank you for choosing an
Aidacare Aspire Aura Lifter.

This product has been designed to offer maximum safety
for the user and reduced manual handling for the carer.
Aidacare standing lifters are for indoor use only.



IMPORTANT: Do not use the Aidacare Aspire Aura Lifter without first reading this user manual.



This product features the UKCA mark, in compliance with Part II UK MDR 2002 (as amended) Class 1.



This product features the CE mark, in compliance with the Medical Devices Regulation 2002 (as amended) Class 1, and the Medical Device Regulation 2017/745

© Aidacare Limited 2025

No part of this user manual may be copied, distributed, reproduced, scanned, or stored in any electronic database, whether in whole or in part, by any means.

Due care has been taken to ensure all the information contained in this user manual is correct at the time of printing. All measurements, pictures, colours and weight capacities are to be used as a guide only. We reserve the right to modify the design or appearance of any product displayed in this user manual without prior notice.

TABLE OF CONTENTS

1. Symbols Used In This Manual	4
2. Symbols Used on The Product	5
3. Overview	5
4. Safety Precautions & Warnings	6
5. Intended Use	7
6. Product Features	9
7. Parts Glossary	10
8. Assembly	11
9. Preliminary Checks	13
10. Lifter Operation	14
11. Sling Compatibility	17
12. Lifting Guide	18
13. Care & Maintenance	21
14. Compliance	22
15. Warranty & Service	22
16. Specifications	24
17. Troubleshooting	27
18. Recycling Instruction	28
19. Manufacturer, EU Representative & Importer Details	29

1. SYMBOLS USED IN THIS MANUAL

The symbols below are used throughout this user manual and on the product to identify warnings and important information. It is very important for you to read them and understand them completely.



WARNING! Indicates a potentially hazardous condition/situation. Failure to follow designated procedures can cause either personal injury, component damage or malfunction. On the product, this icon is represented as a black symbol on a white triangle with a black border.



ALWAYS! These actions should be performed as specified. Failure to perform mandatory actions can cause personal injury and/or equipment damage. On the product, this icon is represented as a white infinity symbol on a black dot with a white border.



DO NOT! These actions are prohibited. These actions should not be performed at any time or in any circumstances. Performing a prohibited action can cause personal injury and/or equipment damage. On the product, this icon is represented as a white symbol with a black circle and black slash.

2. SYMBOLS USED ON THE PRODUCT



Please note: Sticker is sample only and not to scale



Product Code



Serial Number



Manufacturer



Importer



Country of Manufacture



Type B as per IEC60601-1



CE Mark



UKCA Mark



Safe Working Load



Read User Manual



Caution



Medical Device



Authorised Representative in EU



Includes Electronics components and shouldn't be mixed with General household waste

3. OVERVIEW

The **Aidacare Aspire Aura Lifter** is an ergonomically designed lifter with a generous safe working load (SWL) of 250kg / 39st.

This lifter is ideally suited as a familiar and reliable solution for institutional and aged care environments.

The Aidacare Aspire Aura Lifter allows patients to be transferred from sitting to standing and vice versa with comfort and safety.

The Aspire range of patient handling solutions feature industry leading TiMotion electronics and have been designed and tested to comply with ISO 10535:2024.

4. SAFETY PRECAUTIONS & WARNINGS

SAFETY CONSIDERATIONS



ALWAYS ensure that attendants have read this guide before operating this lifter.



ALWAYS use slings that are assessed and considered suitable by a trained healthcare professional.



ALWAYS ensure the area around the lifter and patient is clear of obstructions.



ALWAYS minimise the distance over which the patient is being transferred by positioning support surfaces as close as possible.



DO NOT operate the lifter without training in the safe operation of lifters and slings. **IF IN DOUBT DO NOT USE.**



DO NOT use the lifter where any doubt exists regarding the safety of the standing lifter including but not limited to wear or damage with particular importance to be placed on the yoke and lifter sling attachment points.



DO NOT use the lifter with slings showing any signs of wear or damage, including fraying.



DO NOT exceed the 250kg / 39st safe working load of the Aidacare Aidacare Aspire Aura Lifter.



DO NOT use the lifter as a means of transportation over distances in excess of 3 metres. It is not designed as a transportation device.

5. INTENDED USE

The Aura Floor Lifter has been designed to stand and transfer human patients with the assistance of one carer or attendant. This product is suitable for indoor areas only and it should **NEVER** be used outdoors.

All Aura Floor lifters should **ONLY** be used with Aidacare approved patient slings, which have been chosen and assessed by a competent trained health professional. For a complete list of all compliant lifting slings please contact Aidacare.



IMPORTANT – only approved slings and accessories are compatible with this lifter. If you are unsure please contact Aidacare.

The correct and appropriate use of The Aidacare Aspire Aura Lifter reduces the risks associated with manual patient handling. The lifting and transferring of patients should always be assessed and planned by a trained health professional.

This lifter is designed for indoor use **ONLY** and should **NOT** be used outdoor under any circumstances.



This is the direction of travel for which this lifter has been designed.

How to Use Correctly:

The boom of the lifter is designed to be lifted only by an electric actuator.

Aidacare Lifters and Standing Lifters do not pull downwards during lowering. This safety spline feature is designed to avoid entrapment and crush injuries.

This safety feature means that it is physically possible to raise the lifter boom by hand on some lifter models.

 **DO NOT** raise the lifter boom by hand or any other means except under direct drive from the electric actuator fitted to the lifter.

Raising the boom can cause it to become stuck in an elevated position. Under load this can result in the patient to free fall and risks catastrophic injury to the patient and/or carer.

 **ALWAYS** use the handset or control unit buttons to raise and lower the boom of the lifter. This will ensure correct and safe functioning at all times.



WARNING: DO NOT manually lift the boom of lifters.

6. PRODUCT FEATURES



7. PARTS GLOSSARY



1	Boom	8	Push Handle
2	Yoke	9	Lift Actuator
3	Battery	10	Leg Actuator access cover
4	Control Unit	11	Electronics Cover
5	Emergency Lowering Knob	12	Leg Protector cover
6	Emergency Stop	13	Rear Breaking Castor
7	Handset	14	Front Castor

8. ASSEMBLY

TOOLS REQUIRED

- Impact driver or drill (5 & 6mm allen key attachment)
- Torque wrench
- 17mm & 13mm spanner

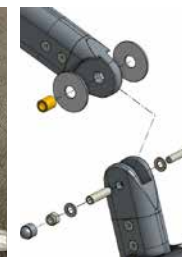
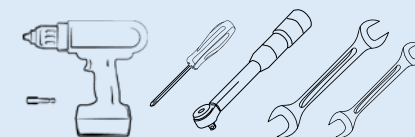

1. Remove all parts from the carton

Assemble boom and mast as shown. Apply grease to brass and aluminium sleeve.

2. Remove the pin

Remove the locking pin from the base and 2 front screws from the mast.



3. Insert mast into base

Mount and secure 2x screws on the front of the base with a size 5 Allen key. Secure the pin with a size 4 Allen key.

4. Assemble the actuator to the lifter

Apply medium strength Loctite to the bolt threads when installing actuator hardware.



Warning: Do not crush cables installed in the base. Make sure all bolts have pre applied threadlocker.



5. Mount the push handle

Mount the push handle onto the mast in the orientation shown and fasten 6x screws with a size 5 Allen key.



6. Assemble the yoke

Assemble the yoke of the lifter with the pin and provided spacers as shown. The bolt should locate through the pin and spacers. Apply Loctite to the bolt threads and secure hardware. Apply grease to the aluminium sleeve.

8.2 ELECTRONICS ASSEMBLY

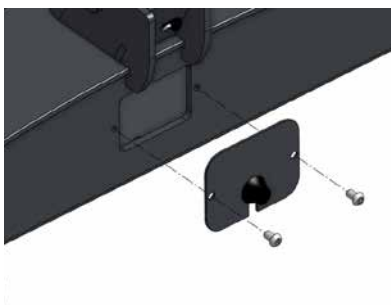

1. Open rear panel

Open up the rear panel on the base of the lifter.

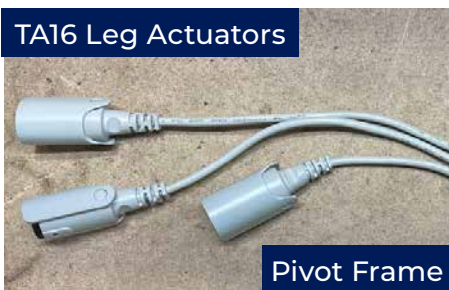

2. Locate the leg actuator plugs

Locate the leg actuator plugs and connect the 3 way splitter cable to the sockets marked Legs. If a pivot frame is used connect the last plug coming from the mast to the 3rd socket marked pivot frame.



3. Position the cable

Neatly position the cable within the base frame, ensuring excess cable neatly positioned away from moving parts.

4. Thread last cable

Thread last remaining cable end through the panel and rubber cable gland and attach to the M2 port on the control box.

5. Close up base panel.

6. Connect the main lift actuator to M1 port

7. Connect the handset to the handset port

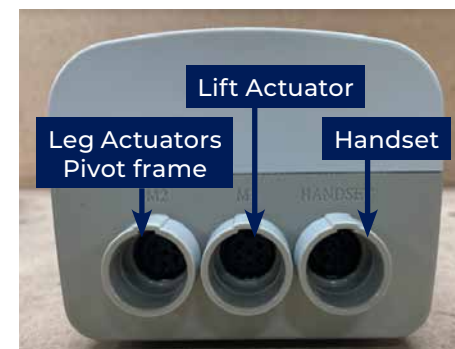

9. PRELIMINARY CHECKS

After charging the battery these checks should be completed prior to initially using the lifter:

1. Check handset functionality is correct.
2. Check to see that all indicator lights are functioning.
3. Check that the emergency stop button causes the lifter to stop.
4. Check emergency lowering function.
5. Check that all leads are inserted, fastened and clear of the rear castors.

10. LIFTER OPERATION

10.1 HANDSET

1 Raise / Lower Function Buttons

Press to move the standing lifter up and down. Release to stop movement. Always ensure the environment is free of obstacles that may impede movement.

2 Leg Spread Function Buttons

Press to open and close the standing lifter's legs. Release to stop movement. This allows you to fit the lifter around furniture, such as chairs. Always ensure the environment is free of obstacles that may impede movement. Beware of obstacles at all times to ensure boom and legs can move freely.

3 Pivot Frame Function Buttons

Press to pivot the standing lifter clockwise and anti clockwise. Release to stop movement. Always ensure the environment is free of obstacles that may impede movement.

4 Battery Charge Indicators

Battery charge indicators will flash when battery reaches maximum recommended discharge of 18 volts while the standing lifter is under load.

5 Service Indicator

This will illuminate to show that a service is required. Service should be carried out every 6 months or 8,000 lift cycles – whichever comes first.

6 Overload Indicator

A full load test needs to be completed every 12 months. contact your Aidacare Aspire dealer to arrange a service.



10.2 EMERGENCY LOWERING

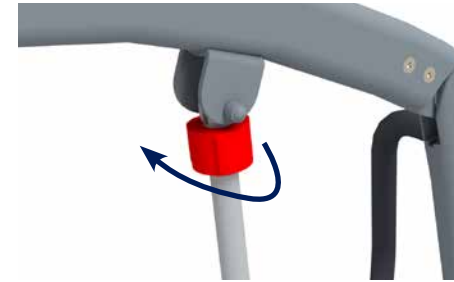

To activate the emergency lowering twist the red ring in a clockwise direction at the end of the actuator. This allows the patient to be fully lowered in the event of a fault in the lifter or discharged batteries.

10.3 CHARGING THE BATTERY

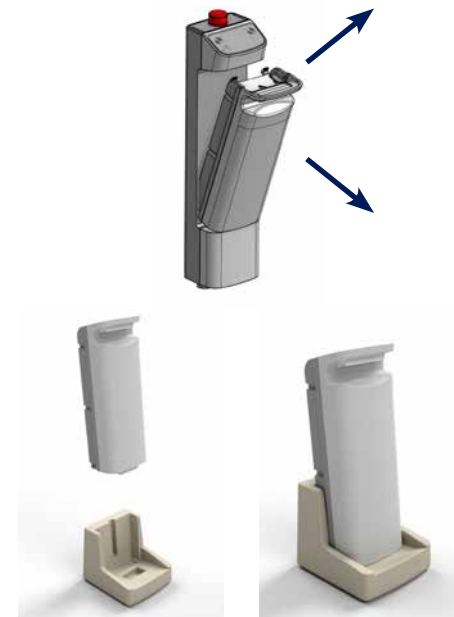

The Aspire lifter is supplied with a charging cradle and is compatible with standard Australian and United Kingdom power outlets.

Remove the battery by lifting the lever on the front of the battery to unlock. Pull out the battery and lift away to remove.

To charge sit the removable battery on to the cradle.



When charging refer to the indicator light on the power pack.

Amber - charging

Green - fully charged



WARNING: Continued use of this equipment without conducting regular inspection or servicing will seriously compromise the carer and patients safety.

10.4 CHARGING DO'S AND DON'TS



NEVER allow the battery to fully discharge before recharging. Allowing batteries to fully discharge can reduce the useful life of a battery.



ALWAYS Charge the battery whenever possible, to maximise battery life. Allowing batteries to fully discharge can reduce the useful life of a battery.



ALWAYS inspect all cables particularly the mains power cable on the charger for any damage; replace if any signs of damage or wear are visible.



ALWAYS clean the actuators, control box, charger, battery and handset at regular intervals to remove dust/dirt.

10.5 CASTORS



To **engage the castor brake** place your foot on the brake pedal and apply sufficient downward force to move it into the lock position.



To **disengage the castor brake** simply place the point of your toe underneath the brake pedal and lift-up.

11. SLING COMPATIBILITY

Aidacare has a range of Aspire slings designed for use with the Aidacare Aspire lifters.

This lifter may also be suitable for use with other brands of slings provided that the design is compatible with a hook yoke/spreader bar design. To confirm if a sling is compatible with any of the Aidacare Aspire range of lifters, contact Aidacare.



Deluxe General Purpose



Deluxe General Purpose with Head Support



Mesh General Purpose Sling



Mesh General Purpose Sling with Head Support

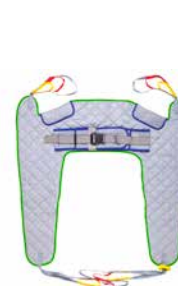

Deluxe Hygiene Access Sling



Deluxe Hygiene Access Sling with Head Support



Deluxe Hammock Sling with Head Support
(Mesh & Super Soft Fabric Available)



Hybrid Patient Sling

12. LIFTING GUIDE

It is important that carers are familiar with manual handling techniques along with any sling instructions, prior to completing any patient lifts. All patient's should have the correct sling and transfer techniques assessed by a qualified health professional. Explaining the lift process to the patient is important to ensure patient comfort and confidence and whenever possible two carers should conduct patient lifts for additional safety.



BED

1. User sling positioning

After rolling the user on their side, position the sling along the length of the user.

Ensure that the user is positioned centrally on the sling when rolled into a supine position.



2. Attaching the sling to the yoke

The lifter should be positioned with the legs sufficiently under the bed to allow the boom and yoke to be positioned over the user's chest. Once in place, attach the loops/clips of the sling to the yoke/frame.



3. Lifting the user

Before commencing, ensure that the rear castor brakes are off, so that the lifter can adjust its centre of gravity during the lift. As the straps pull tight but before the user's bottom leaves the bed, ensure the sling is positioned appropriately and that the sling loops or clips are attached securely.

If the above sling application remains correct, the lift can be commenced. Always position the two support surfaces that the lift is taking place between as close together as possible to avoid moving the user over distances in the sling.



CHAIR

1. User sling positioning

Ensure that the user is ready, then slowly lean them forward to allow the sling to be slid down behind the back until the bottom of the sling is positioned under the coccyx.

The sling leg straps can now be slid underneath each thigh, remaining careful to avoid creasing or bunching of the fabric.



2. Attaching the sling to the yoke

Ensure that the lifter legs are open to the appropriate width and slowly position it as close to the front of the chair as possible – be careful to keep the boom and add yoke/framer of the user during this process.

Once the yoke/frame is at chest height on the user the sling loops / clips can be attached.

For chair lifts, the rear brake castors should not be used to ensure the lifter can locate its centre of gravity easily.

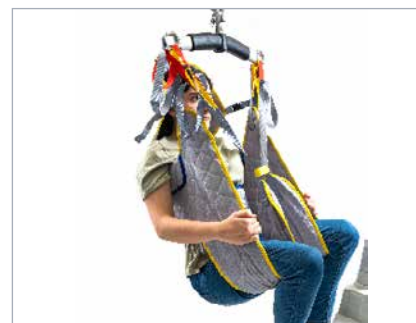

3. Lifting the user

Raise the yoke/frame until the straps of the sling pull tight. As the straps pull tight but before the user's bottom leaves the chair, ensure the sling is positioned appropriately and that the sling loops or clips are attached securely.

Lift the user only to a height needed to successfully transfer to the desired support surface.

Always position the two support surfaces that the lift is taking place between as close together as possible to avoid moving the user over distances in the sling.

FLOOR

Generally, a floor lift is only required in the event of a fall or emergency. Therefore it is important that a medical professional has assessed the patient and given the all clear for a lift to be carried out.



1. User Sling Positioning

After rolling the user on their side, position the sling along the full length of the user.

Ensure that the user is positioned centrally on the sling when rolled into a supine position.



2. Attaching the sling to the yoke

The lifter should be positioned from the foot end with the lifter legs opened to ensure maximum area for the user to be lifted. The rear castors should be locked.

It is important to continually communicate with a user during floor lifts as they may often be in shock or disoriented and need reassurance.



3. Lifting the user

When carrying out a floor lift, the castors should be locked throughout the lifting procedure. As the straps pull tight but before the user leaves the floor, ensure the sling is positioned appropriately and that the sling loops are attached securely.

If the user sling position remains correct, the lift can be commenced. Lift the user only to a height needed to successfully transfer to the desired support surface.

Always position the two support surfaces that the lift is taking place between as close together as possible to avoid moving the user over distances in the sling.

13. CARE & MAINTENANCE

To prolong the working life of the lifter and for trouble free operation it is recommended that periodic inspections should be performed routinely by a person who is suitably qualified and well acquainted with the design, use and care of patient lifters.

If inspection reveals that the safety of the lifter is jeopardised in any way the lifter should be **IMMEDIATELY WITHDRAWN FROM SERVICE**, tagged as such and the owner notified.

COMMON CHECKS, MAINTENANCE AND CLEANING

- Check castors are fastened securely to the frame
- Castors should run and swivel smoothly – if hair or other fibres have built up within the castor this should be removed
- Check that the brakes on the rear castors function normally
- Clean surfaces with a pH neutral detergent – chlorine and phenol based detergents should not be used as these may damage lifter components
- All moving parts and pivot points should be checked for fatigue and lubricated if necessary
- All electrical components should be checked for normal function including battery and battery charger
- The actuator shaft should only be wiped with a cloth (**DO NOT** lubricate)

Should you have any questions, contact Aidacare.

AS A MINIMUM A FULL SERVICE SHOULD BE COMPLETED EVERY 6 MONTHS AND THE LOAD TEST EVERY 12 MONTHS TO MAINTAIN WARRANTY.

Electrical Test & Tag – where lifters are in use in a commercial environment then the testing regime applied should align with the risk assessment made by the owner for safety and other compliance requirements.

TO MAINTAIN GLOBAL STANDARDS COMPLIANCE UNDER AS ISO 10535-2024 A FULL SWL TEST MUST BE COMPLETED EVERY 12 MONTHS.

14. COMPLIANCE

This lifter is manufactured to the AS/NZS 10535:2024 standard and compliant production facilities in PR China to strict quality control standards.

Aspire lifters are manufactured and independently tested to the market relevant compliance standards.

Labels on the lifter address compliance requirements and users should familiarise themselves with these prior to use.

15. WARRANTY & SERVICE

FLOOR LIFER AND ELECTRONICS

Aidacare warrants its products to be free from defects in materials and workmanship under normal use and service and will within the period stated below, from the date of purchase, repair or replace without cost to the original customer, any part assembly or portion thereof which shall be returned to Aidacare and from OUR inspection shows to be defective.

1. Lifter Frame – 5 years
2. Timotion Actuator and Timotion Controller – 3 years (excluding Battery Pack)
3. Timotion Battery Pack & Handset – 12 month manufacturer's warranty subject to stringent fair wear and tear clauses (please contact AIDACARE for a copy of this information)

WARRANTY IS CONTINGENT UPON SERVICING BEING COMPLETED FOR THE LENGTH OF THE WARRANTY PERIOD.

AIDACARE cannot be held responsible for any personal injury, damage to the lifter or damage to property as a result of the improper or unsafe use of the product.

No warranty claim shall apply where the product or any part thereof has been modified, varied, altered or damaged either accidentally or through improper or negligent use.

No warranty claim shall apply where the lifter is repaired or serviced by parties other than those accredited and or approved by Aidacare.

Warranty does not extend to items or components which may require replacement due to normal wear and tear (e.g. castors, plastic molded components, foam padding (where fitted) and painted surfaces) for which AIDACARE nor its distributors can be held responsible.

BATTERIES

Batteries carry a limited warranty from the original manufacturer which is subject to a stringent wear and tear clause. Battery faults due to defect in original manufacture typically become apparent within the first two months of use.

Any gradual deterioration in performance after this period is typically associated with fair wear and tear, misuse and accidental damage, and as such is not covered by the Timotion manufacturer's warranty.

ALL WARRANTIES MADE ARE BACK TO BASE WARRANTIES MEANING THAT ANY PARTS OR WHOLE STANDERS REQUIRING REPAIR NEED TO BE RETURNED TO THE NEAREST AIDACARE SERVICE CENTRE AT THE CUSTOMER'S EXPENSE – PLEASE CONTACT AIDACARE FOR A CURRENT LIST OF SERVICE CENTRE LOCATIONS.

SPARE PARTS

Spare parts list available upon request from Aidacare.

CUSTOMISATION AND MODIFICATION

All lifter customisation, modifications and or alterations made to this product are considered as “custom” changes. These may cause the product to no longer meet safety standards and should be considered prior to commencement.

Any customisation or modification of the lifter is not warranted by Aidacare and will void the warranty.

16. SPECIFICATIONS

Product Code	LSS390615	LSS390615 – UK
Safe Working Load (SWL)	250kg	39st
Base Length	1378mm	54.3"
External Base Width	682 - 1301mm	26.8" - 51.2"
Internal Base Width	518 – 1150mm	20.4" – 45.3"
Base Width Adjustment	Electric	
Base Height / Under Bed Clearance	131mm	5.2"
Minimum Height of Spreader Bar	437mm	17.2
Maximum Height of Spreader Bar	1788mm	70.4"
Lifter Weight	38kg	83.7lb
Warranty	Frame: 5 Years Electronics: 3 Years Battery Pack and Handset: 1 Year	
Under Base Height	49mm	1.9"
Maximum Overall Height	2048mm	80.6"
Front Castor Diameter	100mm	4"
Rear Locking Castor Diameter	125mm	5"
Turning Diameter	1453mm	57.2"
Weight Of Heaviest Part (Base Assembly)	19.6kg	43.2lb
Handle Height	883 - 1305mm	34.8" - 51.4 "
Sound Level	<40Db@ 1m	
Electrical Approval	IEC 60601-1:2005 IEC 60601-1:2005/AMD1:2012 IEC 60601-1:2005/AMD2:2020	

Box Contains: Base with 4 castor wheels, mast and boom with yoke, TiMotion handset, TiMotion battery charger, TiMotion battery, TiMotion controller, push handle. Screws, bolts, nuts, washers, plastic caps and tool kit.

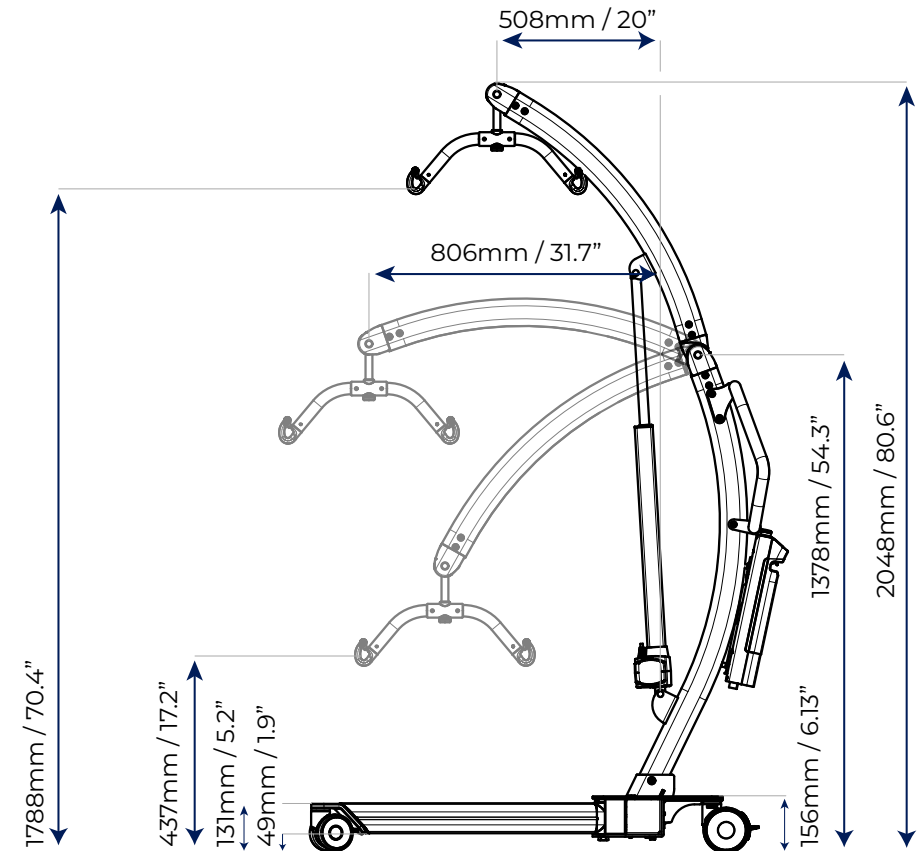

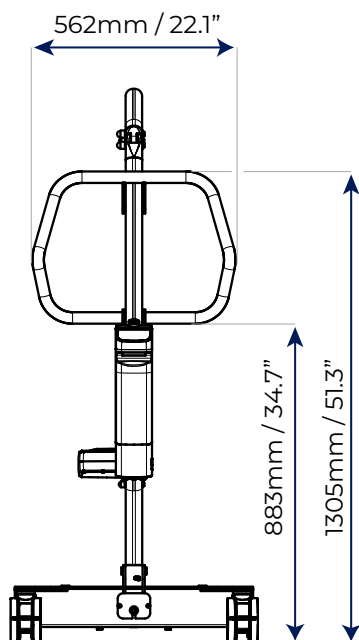
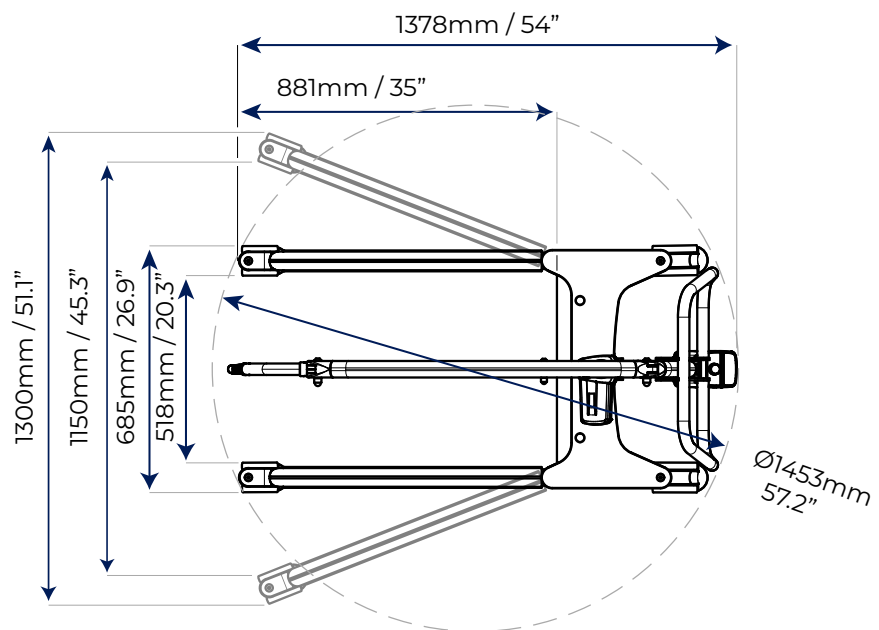

17. TROUBLESHOOTING

WARNING: TROUBLESHOOTING SHOULD ONLY BE CARRIED OUT BY AIDACARE AUTHORISED SERVICE TECHNICIANS WHO ARE TRAINED IN SERVICING THE ELECTRICAL AND MECHANICAL FEATURES OF THE PATIENT STANDER.

The following is a guideline only to general troubleshooting.

Before carrying out any troubleshooting:



- CHECK TO ENSURE the RED emergency stop button is NOT pushed in.
- CHECK TO ENSURE maintenance procedures have been followed.
- CHECK TO ENSURE all lead connections are secure.
- CHECK TO ENSURE the battery is fully charged.

Problem	Potential Fault	Action
<ul style="list-style-type: none"> • Warning alarm can be heard in control unit 	<ul style="list-style-type: none"> • Battery is discharged • Battery may be faulty 	<ul style="list-style-type: none"> • Recharge battery • Replace battery
<ul style="list-style-type: none"> • Power LED on charger does not illuminate 	<ul style="list-style-type: none"> • Not connected to power • Fuse blown • Faulty Charger 	<ul style="list-style-type: none"> • Check plugged in to power point and switched on • Replace fuse • Repair or replace charger
<ul style="list-style-type: none"> • Actuator not running/no click heard from control unit when buttons pressed 	<ul style="list-style-type: none"> • Faulty control unit • Faulty handset 	<ul style="list-style-type: none"> • Repair or replace control unit
<ul style="list-style-type: none"> • Actuator not running but control unit clocks when buttons pressed 	<ul style="list-style-type: none"> • Actuator plug not inserted fully into control unit • Faulty actuator • Faulty control unit 	<ul style="list-style-type: none"> • Check plugs are completely inserted into control unit ports • Repair or replace actuator and or control unit

<ul style="list-style-type: none"> • Actuator not lifting properly or running slowly 	<ul style="list-style-type: none"> • Discharged or faulty battery • Weight in excess of safe working load (SWL) • Faulty actuator 	<ul style="list-style-type: none"> • Recharge or replace battery • Repair or replace actuator
<ul style="list-style-type: none"> • No clicking in control box when buttons pressed 	<ul style="list-style-type: none"> • Emergency stop button pressed • Battery completely discharged • Battery fuse faulty • Faulty control unit 	<ul style="list-style-type: none"> • Release emergency stop button • Recharge battery • Repair or replace control unit
<ul style="list-style-type: none"> • Actuator only works in one direction 	<ul style="list-style-type: none"> • Faulty handset • Faulty control unit • Emergency lower release activated 	<ul style="list-style-type: none"> • Repair or replace handset • Repair or replace control unit • Check emergency actuator release is reset

18. RECYCLING INSTRUCTION

This product is fitted with electronic components and should not be mixed with general household waste. Please follow the diagram below to identify the materials on the product. Old batteries and electronics are to be taken to your nearest recycling centre for recycling or contact your retailer.

-  Lead Battery (Pb)
-  Waste of Electrical and Electronic Equipment (WEEE)
-  Metals

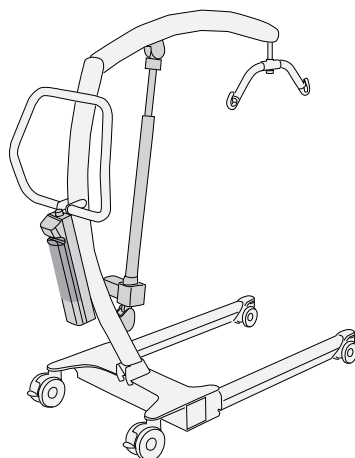

19. MANUFACTURER, EU REPRESENTATIVE & IMPORTER DETAILS

If you have any questions, you can contact:



Manufacturer:

Aidacare Pty Ltd

ABN 40 134 398 833

Building 3A, 1 Moorebank Avenue, Moorebank NSW 2170 Australia

1300 133 120 | product@aidacare.com.au

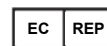

EU Representative:

European Healthcare & Device Solutions (Ireland) Ltd

Stratton House, Bishopstown Road, Cork T12 Y9TC Ireland

info@europeandevicesolutions.eu



Importer:

Aidacare Ltd

Registration 13785408

Arcadia House, Maritime Walk, Ocean Village, Southampton SO14 3TL United Kingdom

01622 541235 | info@aidacare.co.uk

SERVICE LOG BOOK

Year 1	Date: _____
Service Type: _____	
Condition Report: _____	

Inspected by: _____	Signature: _____
Action taken: _____	Date: _____

Year 2	Date: _____
Service Type: _____	
Condition Report: _____	

Inspected by: _____	Signature: _____
Action taken: _____	Date: _____

Year 3	Date: _____
Service Type: _____	
Condition Report: _____	

Inspected by: _____	Signature: _____
Action taken: _____	Date: _____

Year 4	Date: _____
Service Type: _____	
Condition Report: _____	

Inspected by: _____	Signature: _____
Action taken: _____	Date: _____

Year 5	Date: _____
Service Type: _____	
Condition Report: _____	

Inspected by: _____	Signature: _____
Action taken: _____	Date: _____

AIDACARE PTY LTD

Building 3A, 1 Moorebank Avenue,
Moorebank NSW 2170
Australia

1300 133 120 | aidacare.com.au

AIDACARE LIMITED

Arcadia House, Maritime Walk,
Ocean Village, Southampton SO14 3TL
United Kingdom

01622 541235 | aidacare.co.uk

MADE IN PRC

ABUM29.7 170325

