

NOVA STANDING LIFTER

USER MANUAL



Congratulations and thank you for choosing an
Aspire Nova Standing Lifter.

This product has been designed to offer
maximum safety for the user and reduced manual
handling for the carer.

Aspire standing lifters are for Indoor use only.



IMPORTANT: Do not use the Aspire Nova Standing Lifter without having first read
this user manual



This product Features the UKCA mark, in compliance with Part II UK MDR 2002
(as amended) Class I.



This product features the CE mark, in compliance with the Medical Devices Regulation 2002
(as amended) Class I, and the Medical Device Regulation 2017/745

© Aidacare Limited 2025

No part of this user manual may be copied, distributed, reproduced, scanned or stored on any electronic
database, whether in whole or in part in any form or by any means.

Due care has been taken to ensure all the information contained in this user manual is correct at the time
of printing. All measurements, pictures, colours and weight capacities are to be used as a guide only. We
reserve the right to modify the design or appearance of any product displayed in this user manual without
prior notice.

TABLE OF CONTENTS

1. Symbols Used In This Manual	4
2. Symbols Used On The Product	5
3. Overview	5
4. Safety Precautions & Warnings	6
5. Intended Use	7
6. Product Features	9
7. Parts Glossary	11
8. Assembly	12
9. Preliminary Checks	13
10. Standing Lifter Operation	14
11. Standing Guide	18
12. Sling Compatibility	19
13. Care & Maintenance	20
14. Compliance	21
15. Warranty & Service	21
17. Specifications	23
16. Troubleshooting	25
18. Recycling Instruction	26
19. Manufacturer, EU Representative & Importer Details	27

1. SYMBOLS USED IN THIS MANUAL

The symbols below are used throughout this user manual and on the product to identify warnings and important information. It is very important for you to read them and understand them completely.



WARNING! Indicates a potentially hazardous condition/situation. Failure to follow designated procedures can cause either personal injury, component damage or malfunction. On the product, this icon is represented as a black symbol on a white triangle with a black border.



ALWAYS! These actions should be performed as specified. Failure to perform mandatory actions can cause personal injury and/or equipment damage. On the product, this icon is represented as a white infinity symbol on a black dot with a white border.



DO NOT! These actions are prohibited. These actions should not be performed at any time or in any circumstances. Performing a prohibited action can cause personal injury and/or equipment damage. On the product, this icon is represented as a white symbol with a black circle and black slash.

2. SYMBOLS USED ON THE PRODUCT



Please note: Sticker is sample only and not to scale

	Product Code		UKCA Mark
	Serial Number		Safe Working Load
	Manufacturer		Read User Manual
	Importer		Caution
	Country of Manufacture		Medical Device
	CE Mark		Authorised Representative in EU
	Type B as per IEC60601-1		Includes Electronics components and shouldn't be mixed with General household waste

3. OVERVIEW

The **Aspire Nova Standing Lifter** is an ergonomically designed mobile standing lifter with a generous safe working load (SWL) of 250kg / 39st.

This mobile standing lifter is ideally suited as a familiar and reliable solution for institutional and aged care environments.

The Aspire Nova Standing Lifter allows patients to be transferred from sitting to standing and vice versa with comfort and safety.

The proven bull horn shape yoke offers versatility in patient grip points and 2 sling attachment styles to meet various user and carer needs. The height and width adjustable knee pads offer lower leg comfort and security during the lift.

Our range of patient handling solutions feature industry leading TiMotion electronics and have been designed and tested to comply with ISO 10535:2024.

4. SAFETY PRECAUTIONS & WARNINGS

SAFETY CONSIDERATIONS



ALWAYS ensure that attendants have read this guide before operating this lifter.



ALWAYS use slings that are assessed and considered suitable by a trained healthcare professional.



ALWAYS ensure the area around the lifter and patient is clear of obstructions.



ALWAYS minimise the distance over which the patient is being transferred by positioning support surfaces as close as possible.



DO NOT operate the lifter without training in the safe operation of lifters and slings. **IF IN DOUBT DO NOT USE.**



DO NOT use the lifter where any doubt exists regarding the safety of the standing lifter including but not limited to wear or damage with particular importance to be placed on the yoke and lifter sling attachment points.



DO NOT use the lifter with slings showing any signs of wear or damage, including fraying.



DO NOT exceed the 250kg / 39st safe working load of the Aspire Nova Standing Lifter.



DO NOT use the lifter as a means of transportation over distances in excess of 3 metres. It is not designed as a transportation device.

5. INTENDED USE

The Aspire Nova Standing Lifter has been designed to stand and transfer human patients with the assistance of one carer or attendant. This product is suitable for indoor areas only and it should **NEVER** be used outdoors.

All Aidacare Aspire standing lifters should **ONLY** be used with Aidacare approved patient slings, which have been chosen and assessed by a competent trained health professional. For a complete list of all compliant lifting slings please contact Aidacare.



WARNING

IMPORTANT – only approved slings and accessories are compatible with this lifter. If you are unsure please contact Aidacare.

The correct and appropriate use of the Aspire Nova Standing Lifter reduces the risks associated with manual patient handling. The lifting and transferring of patients should always be assessed and planned by a trained health professional.

This lifter is designed for indoor use **ONLY** and should **NOT** be used outdoor under any circumstances



This is the direction of travel for which this standing lifter has been designed.

How to Use Correctly:

The boom of the lifter is designed to be lifted only by an electric actuator.

Aidacare Lifters and Standing Lifters do not pull downwards during lowering.

This safety spline feature is designed to avoid entrapment and crush injuries.

This safety feature means that it is physically possible to raise the lifter boom by hand on some models.



DO NOT raise the lifter boom by hand or any other means except under direct drive from the electric actuator fitted to the lifter.

Raising the boom can cause it to become stuck in an elevated position. Under load this can result in the patient to free fall and risks catastrophic injury to the patient and/or carer.



ALWAYS use the handset or control unit buttons to raise and lower the boom of the lifter. This will ensure correct and safe functioning at all times.



WARNING: DO NOT manually lift the boom of lifters.

6. PRODUCT FEATURES



7. PARTS GLOSSARY



1	Boom	9	Push handle
2	Sling bar / yoke	10	Adjustable knee pads
3	Lift actuator	11	Neoprene calf strap
4	Mast	12	Foot platform
5	Battery	13	Front castors 100mm
6	Cover for lifter leg	14	Rear locking castors 125mm
7	Patient grab handle	15	Emergency lowering function
8	Handset	16	Emergency stop button

8. ASSEMBLY

TOOLS REQUIRED

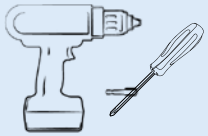

Impact driver or drill
(5mm and 6mm allen
key attachment)

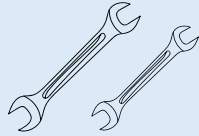

17mm &
13mm spanner

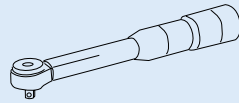

Torque wrench

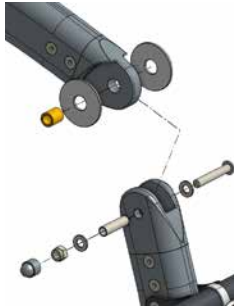

- 1 Remove all parts from the carton. Assemble boom and mast as shown.

NOTE: Apply grease to brass and aluminium sleeve.



- 2 Insert mast into base mount and secure screws at locations shown.

Bolts shown to be tightened to 20Nm.



Make sure all bolts have pre applied threadlocker.



- 3 Attach the knee rest assembly to the mast with 4x bolt and locknuts.



- 4 Assemble the actuator to the boom arm of the lifter. Check and apply medium strength Loctite to the bolt threads and install the actuator hardware.

16Nm recommended torque.



- 5 Hook the foot plate in place using the provided mounting holes in the base.



- 6 Mount the push handle onto the mast in the orientation shown and fasten 4x screws.

- 7 Run the lifter through all functions to ensure everything works as intended.

9. PRELIMINARY CHECKS

After charging the battery these checks should be completed prior to initially using the standing lifter:

1. Check handset functionality is correct.
2. Check to see that all indicator lights are functioning.
3. Check that the emergency stop button causes the standing lifter to stop.
4. Check emergency lowering function. Refer to page 15.
5. Check that all leads are inserted, fastened and clear of the rear castors.

10. STANDING LIFTER OPERATION

10.1 HANDSET

1 Raise / Lower Function Buttons

Press to move the standing lifter up and down. Release to stop movement. Always ensure the environment is free of obstacles that may impede movement.

2 Leg Spread Function Buttons

Press to open and close the standing lifter's legs. Release to stop movement. This allows you to fit the standing lifter around furniture, such as chairs. Always ensure the environment is free of obstacles that may impede movement. Beware of obstacles at all times to ensure boom and legs can move freely.

3 Battery Charge Indicators

Battery charge indicators will flash when battery reaches maximum recommended discharge of 18 volts while the standing lifter is under load.

4 Overload Indicator

A full load test should be completed at least every 12 months by an Aidacare service technician. Contact your Aidacare Aspire dealer to arrange a service.

5 Service Indicator

This will illuminate to show that a service is required. Service should be carried out every 6 months or 8,000 lift cycles – whichever comes first. Contact your Aidacare Aspire dealer to arrange a service.



WARNING

WARNING: Continued use of this equipment without conducting regular inspection or servicing will seriously compromise the carer and patients safety.



10.2 EMERGENCY LOWERING



To activate the emergency lowering twist the red ring in a clockwise direction at the end of the actuator. This allows the patient to be manually lowered in the event of a fault in the lifter or discharged batteries.

10.3 KNEEPAD ADJUSTMENT

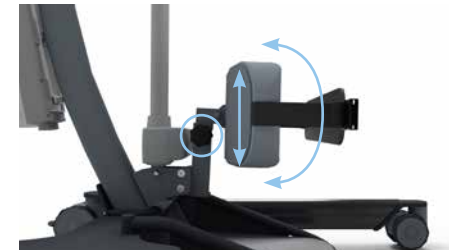

Adjust kneepad height by loosening hand wheel bolt on upright post. Set to desired height and fasten back in place.

Angle of knee pad can be manually adjusted.

10.4 CHARGING THE BATTERY



The Aspire Nova Standing Lifter is supplied with a charging cradle and is compatible with standard AU and UK power outlets.

Remove the battery by lifting the lever on the front of the battery to unlock. Pull out the battery and lift away to remove.



To charge, sit the removable battery on the cradle.



When charging refer to the indicator light on the power pack.

Amber - charging

Green - fully charged

10.5 CHARGING DO'S AND DON'TS



ALWAYS charge the battery whenever possible, to maximise battery life. Allowing batteries to fully discharge can reduce the useful life of a battery.



NEVER allow the battery to fully discharge before recharging. Allowing batteries to fully discharge can reduce the useful life of a battery.



ALWAYS inspect all cables particularly the mains power cable on the charger for any damage; replace if any signs of damage or wear are visible.



ALWAYS clean the actuators, control box, charger, battery and handset at regular intervals to remove dust/dirt. Use house hold detergents to clean the plastic housing only.

10.6 CASTORS



To **engage the castor brake** place your foot on the brake pedal and apply sufficient downward force to move it into the lock position.



To **disengage the castor brake** simply place the point of your toe underneath the brake pedal and lift-up.

SAFE USE

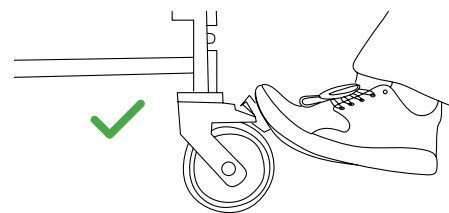
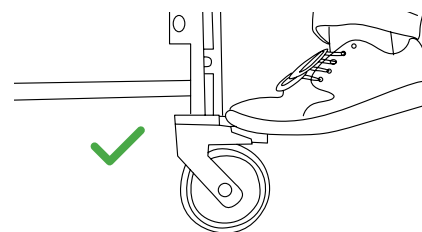

UNSAFE USE

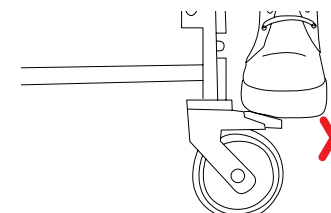
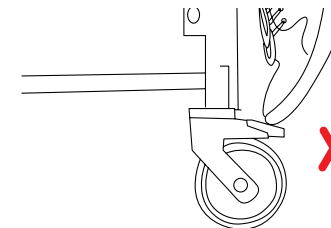

10.7 EMERGENCY STOP

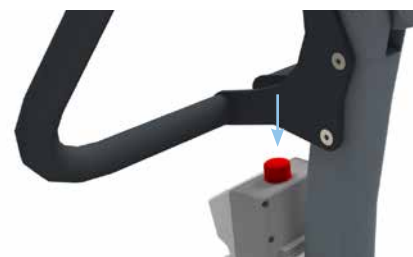

To engage the emergency stop press the red button located on the control unit until it sits flush and remains in position.

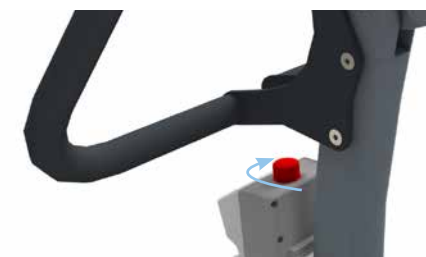

To disengage the emergency stop function twist the red button clockwise until it pops out

11. STANDING GUIDE

It is important that carers are familiar with manual handling techniques along with any sling instructions prior to completing any patient lifts. All patients should have the correct sling and transfer techniques assessed by a qualified health professional. Explaining the lift process to the patient is important to ensure patient comfort and confidence and whenever possible two carers should conduct patient lifts for additional safety.



1 User sling positioning

Ensure that the user is ready and lean them forward. Slide the sling down behind the user until the underarm pads are just below the axilla (arm pit). Pull the straps and loops through under the user's arms and fasten the chest strap in place.



2 Attaching the sling to the yoke

Ensure that the standing lifter legs are open to the maximum width and slowly position it as close to the front of the chair as possible – be careful to keep the boom and yoke clear of the user during this process.

The user's feet should be positioned on the foot platform shoulder width apart. The user should grip the handles on the sling bar for stability.

Once the yoke is at chest height on the user the sling loops can be attached. For chair lifts the rear brake castors should not be used to ensure the standing lifter can locate its centre of gravity easily.

Note: For taller users e.g., over 6ft tall, attach loops to the hooks closest to the user. For other users, attach loops to the hooks in the middle.



3 Lifting the user

As the straps pull tight but before the user's bottom leaves the support surface underneath, ensure the sling is positioned appropriately and that the sling loops are attached securely.

Check that the user is still comfortable and that the sling is correctly positioned. Ask the user to lean back into the sling and straighten their legs as the lifter rises. Raise the user slowly until the user is in a standing position.

12. SLING COMPATIBILITY

The Deluxe Padded Standing Sling has been developed to work seamlessly with the Aidacare range of standing lifters.

This standing lifter may also be suitable for use with other brands of slings. To confirm if a sling is compatible with any of the Aidacare Aspire range of patient lifting systems contact Aidacare.

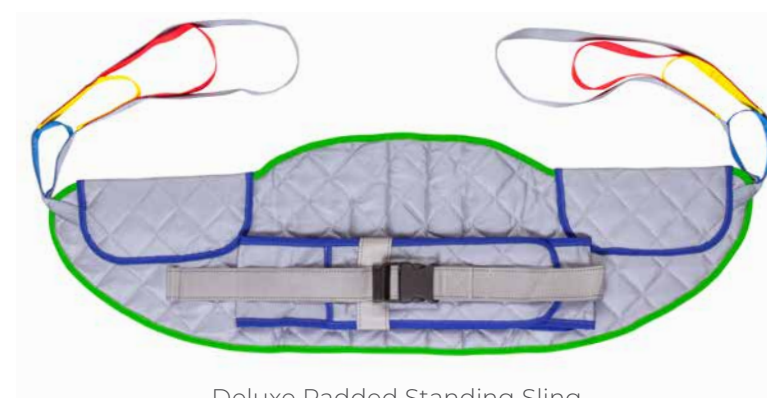

Deluxe Padded Standing Sling

13. CARE & MAINTENANCE

To prolong the working life of the standing lifter and for trouble free operation it is recommended that periodic inspections should be performed routinely by a person who is suitably qualified and well acquainted with the design, use and care of patient standing lifters.

If inspection reveals that the safety of the standing lifter is jeopardized in any way the standing lifter should be **IMMEDIATELY WITHDRAWN FROM SERVICE**, tagged as such and the owner notified.

COMMON CHECKS, MAINTENANCE AND CLEANING

- Check castors are fastened securely to the frame
- Castors should run and swivel smoothly – if hair or other fibres have built up within the castor this should be removed
- Check that the brakes on the rear castors function normally
- Clean surfaces with a pH neutral detergent – chlorine and phenol based detergents should not be used as these may damage standing lifter components
- All moving parts and pivot points should be checked for fatigue and lubricated if necessary
- All electrical components should be checked for normal function including battery and battery charger
- The actuator shaft should only be wiped with a cloth. **DO NOT** lubricate. Should you have any questions, contact Aidacare.

As a minimum, a full service should be completed every 6 months and the load test every 12 months to maintain warranty.

Electrical Test & Tag – where standing lifters are in use in a commercial environment then the testing regime applied should align with the risk assessment made by the owner for safety and other compliance requirements.

To maintain global standards compliance under AS ISO 10535-2024, a full SWL test must be completed every 12 months.

14. COMPLIANCE

This standing lifter is manufactured in ISO compliant production facilities in PR China to strict quality control standards.

Aidacare Aspire standing lifters are manufactured and independently tested to the market relevant compliance standards.

Labels on the standing lifter address compliance requirements and users should familiarise themselves with these prior to use.

15. WARRANTY & SERVICE

15.1 STANDER AND ELECTRONICS

Aidacare warrants its products to be free from defects in materials and workmanship under normal use and service and will within the period stated below, from the date of purchase, repair or replace without cost to the original customer, any part assembly or portion thereof which shall be returned to Aidacare and from OUR inspection shows to be defective.

1. Standing Lifter Frame – 5 years
2. Timotion Actuator and Timotion Controller – 3 years (excluding Battery Pack)
3. Timotion Battery Pack & Handset – 12 month manufacturer's warranty subject to stringent fair wear and tear clauses (please contact AIDACARE for a copy of this information)

Warranty is contingent upon servicing being completed for the length of the warranty period.

AIDACARE cannot be held responsible for any personal injury, damage to the standing lifter or damage to property as a result of the improper or unsafe use of the product.

No warranty claim shall apply where the product or any part thereof has been modified, varied, altered or damaged either accidentally or through improper or negligent use.

No warranty claim shall apply where the standing lifter is repaired or serviced by parties other than those accredited and or approved by Aidacare.

Warranty does not extend to items or components which may require replacement due to normal wear and tear (e.g. castors, plastic moulded

components, foam padding (where fitted) and painted surfaces) for which AIDACARE nor its distributors can be held responsible.

15.2 BATTERIES

Batteries carry a limited warranty from the original manufacturer which is subject to a stringent wear and tear clause. Battery faults due to defect in original manufacture typically become apparent within the first two months of use.

Any gradual deterioration in performance after this period is typically associated with fair wear and tear, misuse and accidental damage, and as such is not covered by the Timotion manufacturer's warranty.

All warranties made are back-to-base warranties, meaning that any parts or whole standers requiring repair need to be returned to the nearest Aidacare service centre at the customer's expense – please contact Aidacare for a current list of service centre locations.

15.3 SPARE PARTS

Spare parts list available upon request from Aidacare.

15.4 CUSTOMISATION AND MODIFICATION

All lifter customisation, modifications and or alterations made to this product are considered as "custom" changes. These may cause the product to no longer meet safety standards and should be considered prior to commencement.

Any customisation or modification of the lifter is not warranted by Aidacare and will void the warranty.

17. SPECIFICATIONS

Product Code	LSS390652	LSS390652-UK
Safe Working Load (SWL)	250kg	39.3st
Base Length	1100mm	43.3"
External Base Width	682 - 1138mm	26.9" – 44.8"
Internal Base Width	519 - 986mm	20.4" – 38.8"
Base Width Adjustment	Electric	
Base Height / Under Bed Clearance	136mm	5.3"
Minimum Height of Spreader Bar	692mm	27.2"
Maximum Height of Spreader Bar	1770mm	69.7"
Standing Lifter Weight	39.6kg	87.3lb
Warranty	Frame: 5 Years Electronics: 3 Years Battery Pack and handset: 1 Year	
Under Base Height	53mm	2"
Maximum Overall Height	1800mm	71"
Front Castor Diameter	100mm	4"
Rear Locking Castor Diameter	125mm	5"
Turning Diameter	1245mm	49"
Weight Of Heaviest Part (Base Assembly)	17.6kg	38.8lb
Handle Height	810 - 1095mm	31.9 - 43.1"
Sound Level	<40Db@ 1m	
Electrical Approval	IEC 60601-1:2005 IEC 60601-1:2005/AMD1:2012 IEC 60601-1:2005/AMD2:2020	

Box Contains: Base with 4 castor wheels, mast and boom with yoke, TiMotion handset, TiMotion battery charger, TiMotion battery, TiMotion controller, push handle. Screws, bolts, nuts, washers, plastic caps and tool kit.

16. TROUBLESHOOTING



WARNING! Troubleshooting should only be carried out by Aidacare authorised service technicians who are trained in servicing the electrical and mechanical features of the patient stander.

The following is a guideline only to general troubleshooting.

Before carrying out any troubleshooting:

- CHECK TO ENSURE the RED emergency stop button is NOT pushed in.
- CHECK TO ENSURE maintenance procedures have been followed.
- CHECK TO ENSURE all lead connections are secure.
- CHECK TO ENSURE the battery is fully charged.

Problem	Potential Fault	Action
<ul style="list-style-type: none"> • Warning alarm can be heard in control unit 	<ul style="list-style-type: none"> • Battery is discharged • Battery may be faulty 	<ul style="list-style-type: none"> • Recharge battery • Replace battery
<ul style="list-style-type: none"> • Power LED on charger does not illuminate 	<ul style="list-style-type: none"> • Not connected to power • Fuse blown • Faulty Charger 	<ul style="list-style-type: none"> • Check plugged in to power point and switched on • Replace fuse • Repair or replace charger
<ul style="list-style-type: none"> • Actuator not running/no click heard from control unit when buttons pressed 	<ul style="list-style-type: none"> • Faulty control unit • Faulty handset 	<ul style="list-style-type: none"> • Repair or replace control unit
<ul style="list-style-type: none"> • Actuator not running but control unit clicks when buttons pressed 	<ul style="list-style-type: none"> • Actuator plug not inserted fully into control unit • Faulty actuator • Faulty control unit 	<ul style="list-style-type: none"> • Check plugs are completely inserted into control unit ports • Repair or replace actuator and or control unit

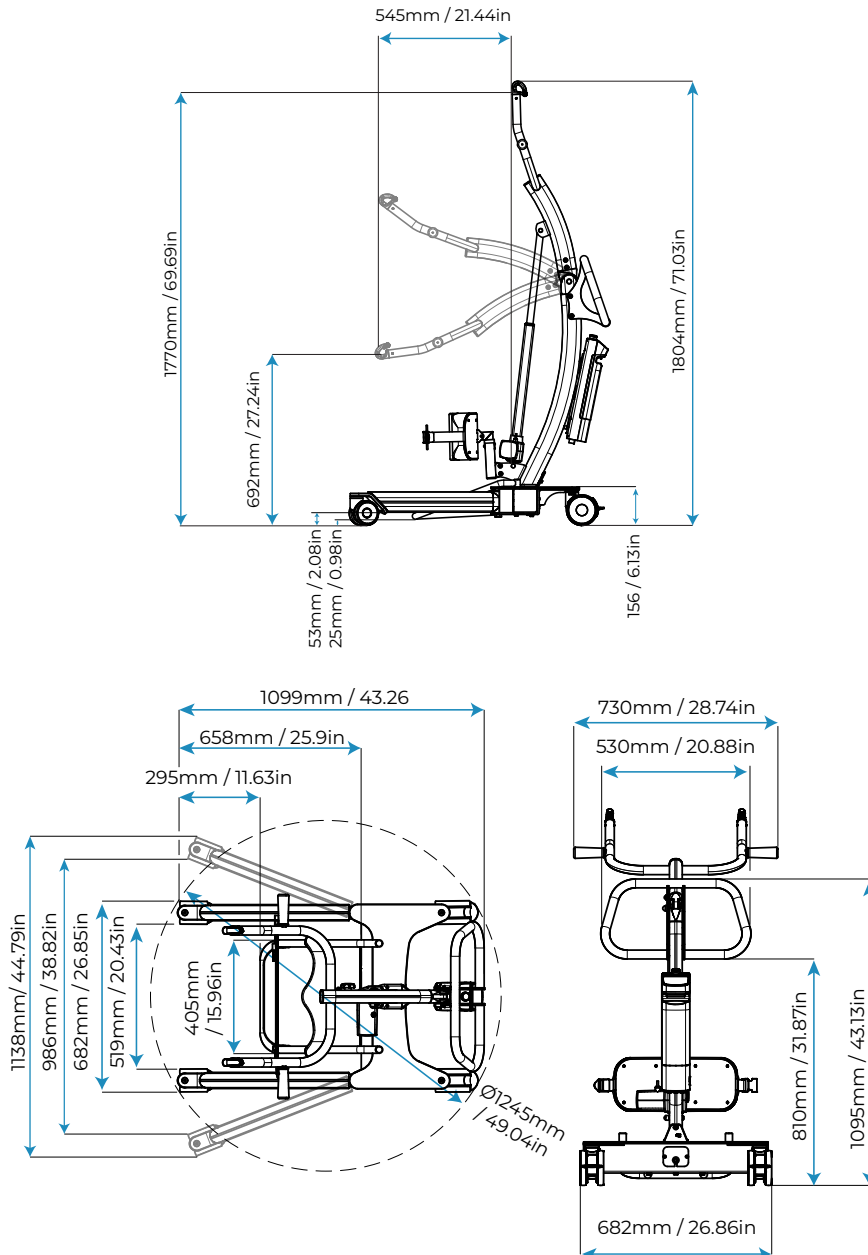

Problem	Potential Fault	Action
<ul style="list-style-type: none"> Actuator not lifting properly or running slowly 	<ul style="list-style-type: none"> Discharged or faulty battery Weight in excess of safe working load (SWL) Faulty actuator 	<ul style="list-style-type: none"> Recharge or replace battery Repair or replace actuator
<ul style="list-style-type: none"> No clicking in control box when buttons pressed 	<ul style="list-style-type: none"> Emergency stop button pressed Battery completely discharged Battery fuse faulty Faulty control unit 	<ul style="list-style-type: none"> Release emergency stop button Recharge battery Repair or replace control unit
<ul style="list-style-type: none"> Actuator only works in one direction 	<ul style="list-style-type: none"> Faulty handset Faulty control unit Emergency lower release activated 	<ul style="list-style-type: none"> Repair or replace handset Repair or replace control unit Check emergency actuator release is reset

18. RECYCLING INSTRUCTION

This product is fitted with electronic components and should not be mixed with general household waste. Please follow the diagram below to identify the materials on the product. Old batteries and electronics are to be taken to your nearest recycling centre for recycling or contact your retailer.



Lead Battery (Pb)



Waste of Electrical and Electronic Equipment (WEEE)



Metals

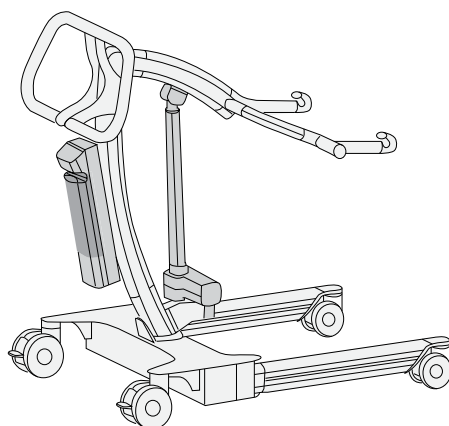

19. MANUFACTURER, EU REPRESENTATIVE & IMPORTER DETAILS

If you have any questions, you can contact:



Manufacturer:

Aidacare Pty Ltd

ABN 40 134 398 833

Building 3A, 1 Moorebank Avenue, Moorebank NSW 2170 Australia

1300 133 120 | product@aidacare.com.au

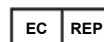

EU Representative:

European Healthcare & Device Solutions (Ireland) Ltd

Stratton House, Bishopstown Road, Cork T12 Y9TC Ireland

info@europeandevicesolutions.eu



Importer:

Aidacare Ltd

Registration 13785408

Arcadia House, Maritime Walk, Ocean Village, Southampton SO14 3TL United Kingdom

01622 541235 | info@aidacare.co.uk

AIDACARE PTY LTD

Building 3A, 1 Moorebank Avenue,
Moorebank NSW 2170
Australia

1300 133 120 | aidacare.com.au

AIDACARE LIMITED

Arcadia House, Maritime Walk,
Ocean Village, Southampton SO14 3TL
United Kingdom

01622 541235 | aidacare.co.uk

MADE IN PRC

ABUM30.5 170325

