



SIERRA SCOOTER

USER MANUAL



Congratulations and thank you for choosing the
Aspire Sierra Scooter.

This user manual contains a description of the product
and important guidelines to ensure correct and safe
use. It is important to read this manual carefully prior
to use. It is especially important to read and follow the
safety requirements.

Aidacare continuously improves products and reserves
the right to change the specifications and functions of
products without notice.

**If you have any queries, please contact your dealer or
Aidacare directly. Contact information is located
on the last page of this manual.**

TABLE OF CONTENTS

1. Intended Use	4
2. Product Description	4
3. Symbols Used In This User Manual	4
4. Symbols Used on This Product	5
5. Warnings & General Safety Information	6
6. List Of Components	18
7. Technical Specifications	19
8. Control Panel	20
9. Battery & Charging the Battery	28
10. Care, Maintenance & Customisation	31
11. Troubleshooting	35
12. Warranty	37
13. Compliance	37
14. Recycling Information	38
15. Manufacturer, Importer & EU Representative	39

1. INTENDED USE

The Aspire Sierra Scooter is a motorised electric scooter for use outdoors primarily on flat surfaces such as pavements, roads, parking lots, and drive ways. It is intended to increase the mobility of people who are both physically and cognitively capable of correctly assessing driving situations and reacting accordingly to them at any time. This product should be used as a tool to assist with mobility or walking difficulties. This product is developed for indoor and limited outdoor use. When used outdoors, the scooter should remain on sealed, level terrain (examples include, but are not limited to, shopping centres, medical centres, flat and level footpaths, and environments with accessibility-focused layouts). Any other use outside of the intended purpose is not advised.

2. PRODUCT DESCRIPTION

The Aspire Sierra Scooter is a four wheeled large mobility scooter. The product is made from steel, so it is durable and strong. This scooter offers great maneuverability, stability, and comfort, which features four independent suspensions. It has a generously padded seat with integrated suspension and backrest with 12" wheels for longer rides. This scooter is powered with two motors fitted to the rear wheels.

3. SYMBOLS USED IN THIS USER MANUAL

The symbols below are used throughout this user manual and on the product to identify warnings and important information. It is very important for you to read them and understand them completely.



WARNING! Indicates a potentially hazardous condition/situation. Failure to follow designated procedures can cause either personal injury, component damage, or malfunction. On the product, this icon is represented as a black symbol on a white triangle with a black border.



ALWAYS! These actions should be performed as specified. Failure to perform mandatory actions can cause personal injury and/or equipment damage. On the product, this icon is represented as a white infinity symbol on a black dot with a white border.



DO NOT! These actions are prohibited. These actions should not be performed at any time or in any circumstances. Performing a prohibited action can cause personal injury and/or equipment damage. On the product, this icon is represented as a white symbol with a black circle and black slash.

4. SYMBOLS USED ON THIS PRODUCT



Stickers shown are not to scale.

#	Product Code	AU:10km/h	Driving Speed		Not Crash Tested
SN	Serial Number	Max 12°	Climbing Angle	i	Read User Manual
	Manufacturer	136kg	Safe Working Load		Caution
CN	Country of Manufacturer	101kg	Product Weight	MD	Medical Device

5. WARNINGS & GENERAL SAFETY INFORMATION

5.1 BEFORE DRIVING FOR THE FIRST TIME

Before taking the first trip with mobility scooter, you should familiarise yourself well the operation of mobility scooter and with the operation elements. Please take your time to read this introduction booklet.

Before driving, please evaluate your personal condition, and fully understand the operation of mobility scooter.



DO NOT assemble, maintain, and operate the mobility scooter before you read this instruction booklet.



WARNING! Observe and obey all pedestrian rules and regulations in which you are riding.



WARNING! Mobility device may only be used on the traffic routes for which it is approved in accordance with the relevant national legislation.



ALWAYS be aware of pedestrians and situations which might require extra care when using your scooter on public walk ways and footpaths.



DO NOT drive your scooter if you are under the influence of alcohol or medication that may affect your ability.



DO NOT try not to drive scooter at night.



ALWAYS turn the key off before getting on or off (see section 8).



ALWAYS please observe all relevant rules and regulations pertaining to pedestrians and road users, at all times when you are driving the scooter.



DO NOT turn the power on before you get in and sit securely on the seat.



WARNING! Be certain that the power is turned off when get in, get out. This will eliminate the possibility of accidentally activating the wigwag controls and causing injury.



WARNING! Keep your weight toward the middle of the deck. Putting most or all of your weight on the edge of the deck may cause an unstable condition.



WARNING! Only one person at a time can ride the Sierra Mobility Scooter. Do not carry passengers under any circumstances.

PRACTICE TIPS

If you are new to drive a scooter, it is a good idea to practice in a clear, safe space on a sound level surface, ie. park or playground.

Basic functions to practice: Wig wag accelerate / Wig wag release / Stop / Reverse / Turn / Ramp proceeding.

Set the speed control to its lowest speed, slightly increase the speed when you are getting familiar with the scooter. (Refer to 8.2, Speed Dial Knob)

Practice operating your scooter in the presence of an attendant. Remember that only with practice will you become a competent driver. Practice these basic functions until you feel that you have control of your scooter.

5.2 CAUTIONS WHEN DRIVING



WARNING! Please do the daily check before your journey always. (Refer to section 10.1, Daily check.)



DO NOT extend your body over the mobility scooter.



WARNING! Please make sure your safety when crossing the level crossing.



WARNING

WARNING! Never place the scooter in freewheel mode when on any sort of an incline or decline. When the scooter is parked, the lever for engaging and disengaging the motors must be locked firmly into the "DRIVE" position. (Refer to section 8.3, N-D lever)



WARNING

WARNING! Cross the railroad crossing, make sure the wheels pass the rail at 90 degree angles, avoid scooter stuck on railroad crossing.



WARNING

WARNING! When descending an incline, use the slowest speed possible. If the descent is faster that you desire, release the throttle lever to stop the scooter. Then press the throttle lever slightly to control the speed.



WARNING

WARNING! Please make sure your safety when crossing the level crossing.



WARNING

WARNING! When crossing the level crossing, please be aware of the wheel and rail are perpendicular.



DO NOT use the mobile phone and wireless mobile devices while driving the scooter.



DO NOT use the batteries of mobility scooter to charge any other electric devices, expect the accessories from original manufacturer.



DO NOT drive on slope over the limit (Refer to section 7, curb climbable)



WARNING

WARNING! Reduce speed when descending to prevent any danger.



DO NOT Increase speed when ascending (Refer to 8.2, Speed Dial Knob)



DO NOT drive to across the obstacle over the limit (Refer to section 5.5)



DO NOT attempt to drive the scooter in rain, wet grass, or any other potentially hazardous condition.



WARNING

WARNING! Ensure that the lights of scooter are turned on while driving at night or in poor visibility.



WARNING

WARNING! Please stop operating the scooter if the batteries have drained, continuous operation may damage the scooter.



ALWAYS follow the local pedestrian traffic rules when driving outside.



WARNING

When turning, reduce your speed and maintain a stable center of gravity. This greatly reduces the possibility of a tip or fall.



DO NOT turn off the power while driving.



DO NOT stretch your body out on the scooter. For maximum stability, lean forward in your body while proceeding up ramps, inclines, curbs, or any low rise.



DO NOT attempt to have your scooter climb or descend an obstacle that is inordinately high. This may cause the scooter to tip.



DO NOT attempt to use your scooter on an escalator.



DO NOT make sharp turns while driving. This may cause the scooter to tip.

5.3 GENERAL SAFETY INFORMATION FOR SCOOTER



WARNING! Batteries should be fully charged before using for maximum performance and longevity. (see section 9)



WARNING! The maximum load of the scooter is 136kg. Do not exceed the maximum permissible load. Exceeding the max. weight rating may result in injury to yourself.



WARNING! The maximum load of the front basket is 3kg exceeding the max. weight may result damage to basket.



WARNING! The mobility device is only designed for use by a single occupant whose maximum weight does not exceed the maximum permissible load of the device. Never use the mobility device to transport more than one person (including children).



DO NOT attempt to carry out maintenance work that is not described in this user manual.



DO NOT change, modify, remove any parts from products especially safety protected parts such as anti-tippers.



WARNING! Completely deflate the tyres (air tyres) before dismantling the rim.



WARNING! Materials and assemblies of scooter is flame resistant.



WARNING! Avoid exposure the scooter to rain, snow, ice, salt, or standing water whenever possible. Maintain and store in a clean and dry condition. Any direct contact with water can cause damage to the scooter and electrical system.



DO NOT remove the anti-tip wheels or modify your scooter in any way that is not authorised.



WARNING! Only use the chargers, accessories, or components supplied as original equipment with your scooter.



WARNING! Immediately stop using the scooter if you encounter a problem with scooter. Turn off the power and contact Aidacare for further checking.

5.4 CAUTIONS WHEN DRIVING ON INCLINES



WARNING! The scooter has been rated to a maximum climbable height, obstacle height, and gap. (Refer to section 7)



WARNING! Never drive on a slope that exceeds the rated slope.



WARNING! The safe working load at different ramp degree (please refer to following picture).

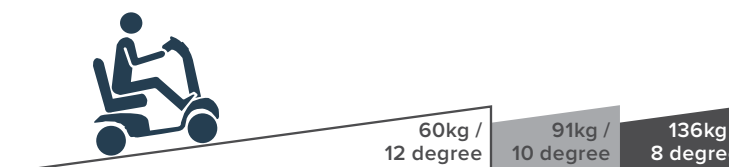

WARNING! Your scooter's ability to travel up inclines is affected by your weight, your scooter's speed, your angle of approach to the incline, and your scooter setup.



WARNING! Please avoid to drive on a long ramp or any uneven terrain to prevent any damage to the motor.



WARNING! The batteries voltage normally will go up when driving on descending road. If the battery voltage becomes too high, the over-voltage protection will be activated by slowing the speed till the scooter stops. (error code :ERR3 will be displaying). Please pull over the scooter to the safe area, release the throttle, and restart the scooter again.



WARNING! When driving down a ramp or uneven terrain, keep the scooter's speed adjustment set to the slowest speed setting to ensure a safely controlled driving.



WARNING! If the speed is too fast, release the throttle control lever, let the scooter stop. When you feel that you again have control of your scooter, push the throttle control lever forward and continue safely driving.



DO NOT turn around at high speed on ascending, descending ramp.

5.5 CAUTIONS WHEN CLIMBING



The maximum height of obstacle and curb that scooter can climb is up to 7cm with run-up (A).



The maximum gap that scooter can drive over is 17cm (B).



Always overcome obstacles straight on at 90 degrees, in one stroke, do not stop halfway! Firstly, make sure the front wheels of the scooter is perpendicular to the obstacle, approach the obstacle slowly until the front wheels touch the obstacle, increase the speed and ensure that the front wheels and rear wheels have moved over the obstacles, and then you may reduce the speed.



When driving scooter on ramp, adjust body center of gravity for scooter stability.



Never attempt to overcome an obstacle when on an uphill or downhill gradient or it may increase the chance of tipping! Adjust the seatback into an upright position before climbing an obstacle, or it may increase the chance of tipping!

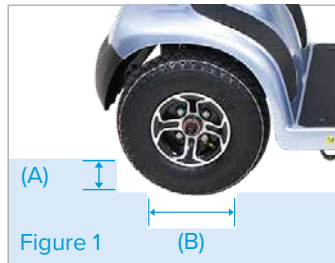

5.6 ELECTROMAGNETIC INTERFERENCE AND WARNINGS



It is very important that you read this information regarding the possible effects of Electromagnetic Interference on your mobility scooter.

Mobility scooters may be susceptible to electromagnetic interference (EMI), which is interfering electromagnetic energy (EM) emitted from sources such as radio stations, TV stations, amateur radio (HAM) transmitters, two-way radios, and mobile phones. The interference (from radio wave sources) can cause the mobility scooter to release its brakes, move by itself, or move in unintended directions. It can also permanently damage the mobility scooter control system. The intensity of the interfering EM energy can be measured in volts per meter (V/m). Each mobility scooter can resist EMI up to certain intensity. This is called its "immunity level." The higher the immunity level, the greater the protection. At this time, current technology is capable of achieving at least a 20V/m immunity level, which would provide useful protection from the more common sources of radiated EMI. The immunity level of this mobility scooter model is not known.

There are a number of sources of relatively intense electromagnetic fields in the everyday environment. Some of these sources are obvious and easy to avoid. Others are not apparent and exposure is unavoidable. However, we believe that by following the warnings listed below, your risk to EMI will be minimised.

The sources of radiated EMI can be broadly classified into three types:

1. Hand-held portable transceivers (transmitters-receivers) with the antenna mounted directly on the transmitting unit. Examples include: citizens band (CB) radios, "walkie talkie," security, fire, and police transceivers, mobile phones, and other personal communication devices.



Some mobile phones and similar devices transmit signals while they are ON, even when not being used.

2. Medium-range mobile transceivers, such as those used in police cars, fire trucks, ambulances, and taxis. These usually have the antenna mounted on the outside of the vehicle.
3. Long-range transmitters and transceivers such as commercial broadcast transmitters (radio and TV broadcast antenna towers) and amateur (HAM) radios.



WARNING

Other types of hand-held devices, such as cordless phones, laptop computers, AM/FM radios, TV sets, CD players, and cassette players, and small appliances, such as electric shavers and hair dryers, so far as we know, are not likely to cause EMI problems to your mobility scooter.

Mobility Scooter Electromagnetic Interference

Because EM energy rapidly becomes more intense as one move closer to the transmitting antenna (source), the EM fields from hand-held radio wave sources (transceivers) are of special concern. It is possible to unintentionally bring high levels of EM energy very close to the motorised scooter control system while using these devices. This can affect mobility scooter movement and braking. Therefore, the warnings listed below are recommended to prevent possible interference with the control system of the mobility scooter.

Warnings

Electromagnetic interference (EMI) from sources such as radio and TV stations, amateur radio (HAM) transmitters, two-way radios, and mobile phones can affect mobility scooters. Following the warnings listed below should reduce the chance of unintended brake release or motorised scooter movement which could result in serious injury.

1. Do not operate hand-held transceivers (transmitters-receivers), such as citizens band (CB) radios, or turn ON personal communication devices, such as mobile phones, while the mobility scooter is turned ON.
2. Be aware of nearby transmitters, such as radio or TV stations, and try to avoid coming close to them.
3. If unintended movement or brake release occurs, turn the motorised scooter OFF as soon as it is safe.

4. Be aware that adding accessories or components, or modifying the mobility scooter, may make it more susceptible to EMI.



WARNING

Some mobile phones and similar devices transmit signals while they are ON, even when not being used

5. Report all incidents of unintended movement or brake release to the distributor listed on the inside front cover of this manual. Note whether there is a source of EMI nearby.

Important Information

1. 20volts per meter (V/m) is a generally achievable and useful immunity level against EMI (as of May 1994). The higher the level, the greater the protection.
2. The immunity level of this product is at least 20/Vm.

5.7 SAFETY WARNING AND INSTRUCTION LABELS



1 Warning Sticker

1. Please read the User Manual carefully before using your scooter.
2. Keep the scooter properly maintained.
3. Do not drive the scooter on slippery surfaces or on slopes over 12°.
4. Do not drive on highways, crowded roads, or unfamiliar areas.
5. Do not turn at high speed in either forward or reverse.
6. Do not wash with water or leave scooter in a humid environment since water can damage the electric parts.
7. Always re-engage the emergency freewheel device after use.



- 2 Do not hang baggage or other objects on the tiller / tiller adjustment lever.



- 3 The scooter is not intended to be used as a seat in a motor vehicle.



- 4 Tie-down points of the scooter. Do not sit or stay on the scooter during transporting.



- 5 N-D Lever Adjustment label which instructs freewheel mode operation. (see section 9.2 for operation)



- 6 Information Sticker states the date of manufacture and serial number of the scooter. (open shroud to access)

This product has been supplied from an environmentally aware manufacturer. It may contain substances that could be harmful to the environment. Recycling must be carried out in accordance with the respective national legal provisions.



- 7 Wiring diagram Label (open shroud to access)

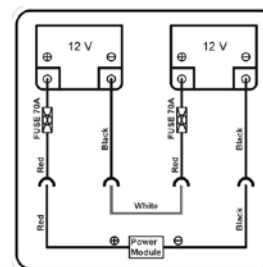

- 8 Model label

SIERRA

6. LIST OF COMPONENTS

- 1 Control Panel
- 2 Charging Port
- 3 Front Basket
- 4 Front Turning Signal
- 5 Headlight
- 6 Tie-down Hook
- 7 Reflector
- 8 Seat fore-aft Adjustment Lever
- 9 Seat Swivel Lever
- 10 Throttle
- 11 Rear Mirror
- 12 Tiller Angle Adjustment
- 13 Key Switch
- 14 Front / Rear Wheels
- 15 Anti-Tipper
- 16 Tail light / Rear Turning Signal / Brake Light
- 17 Adjustable Armrest (Width and height)
- 18 N-D Lever
- 19 Captain Seat



7. TECHNICAL SPECIFICATIONS

Size	Medium (SUCCEEDS 589)
Code & Colour	SCT671261 Arctic Mist SCT671271 Desert Sand
Seat Features	Slide/Swivel/Recline
Overall L x W x H	1290 x 625 x 1150mm
Seat Size D x W	450 x 480 - 530mm
Seat to Deck	440 - 490mm (Ht Adjustable)
Seat to Ground	585 - 635mm
Armrest Height	215mm
Min Turning Radius	1565mm
Ground Clearance	87mm
Max Climbing Angle	12°
Max Driving Speed	10km/h
Driving Range	40km
Wheels Tyres	290mm Pneumatic
Travel Ride	Full Suspension
Battery	2 x 12V 50Ah (Lead Acid)
Product Weight	67kg
Heaviest Part	N/A
Battery Weight	30kg
Power (Nominal Peak)	700W 1400W
Motor	4 Pole
Controller	RHINO 2 120A
Brake System	Electro-Mechanical
Free Wheel Mode	Yes
Charger Size	24V 5A
SWL	136kg

8. CONTROL PANEL

8.1 IDENTIFICATION OF CONTROL PANEL



Figure 5 - HS-589 Control Panel

Item	Function	
1	Power/Self-Diagnostic Warning light	Power on / Error code
2	Battery Gauge	Battery charge display
3	Horn	Press for warning sound
4	Hazard Signal	Press for Hazard on
5	Speed Dial Knob	Adjust the scooter speed
6	Hi/Lo Switch	Press to switch to half of the maximum speed
7	Left / Right Turning Signal	Switch on for left / right turn

8.2 GENERAL OPERATION

Main Key Switch

- Turn key to the **RIGHT** - scooter on.
- Turn key to the **LEFT** - scooter off.
- By turning the key to  to turn on the head light.

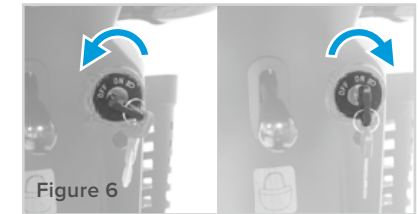

Figure 6



ALWAYS ensure that the scooter is switched off before getting on or off the scooter and before removing any items of the scooter.



WARNING! Turning the scooter OFF whilst driving will bring the scooter to an abrupt stop and danger.

Sleep Mode

- Scooter will go into Sleep Mode with one long beep warning sound if no throttle activity is detected for programmable time period. (Default programmable time is 30 mins.)
- When scooter is in Sleep Mode, the LCD display will be off automatically and the scooter will not respond to commands. Turn on the scooter, control panel will be in standby mode.
- To wake up the scooter, turn the power (key) off and then on again.

Speed Dial Knob

The Rabbit means fast and Turtle means slow.

- The dial knob allows you to adjust the speed of you scooter.



Figure 7



DO NOT set the speed at maximum when operating the scooter. Adjust the speed at maximum when inclining a slope, and adjust to minimum speed when declining.

Turning Signal

- Press down left side to turn on left turning signal.
- Press down right side to turn on right turning signal.



Headlight

- By turning the key to  to turn on the head light.
- Turn the key back to ON, the headlight is off.



Horn

Press down the button to sound buzzer. (Figure 10)



Throttle

- Pull the right throttle to move scooter forward. / Pull the left throttle to move scooter backward. This can be reversed if required by local dealer. (Figure 11)
- These are also your accelerator. The further you depress them, the faster you go. (Subject to the position of speed control)
- Releasing both left/right throttles automatically operates the brakes to slow down and stop.



Electronic Brake

Press the brake button and release the throttle to stop the vehicle. Pressing the brake button while holding the throttle may cause skidding. Be careful to avoid danger. (Figure 11-1)

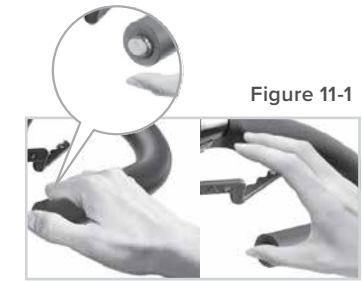

DO NOT pull both right and left throttle at the same time, you might not be able to control the scooter.



ALWAYS ensure the scooter is switched off before getting on or off the scooter.

Tiller Angle Adjustment

Pull the tiller adjustment downwards to adjust tiller's angle and release to lock at a desired comfortable position. (Figure 12)



Seat Swivel Adjustment

Pull the swivel lever upwards to rotate seat left and right. (Figure 13)



Seat fore-aft Adjustment

Set at a comfortable position by lifting lever forward to adjust the seat. (Figure 14)

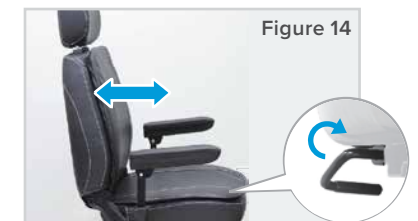

Armrest angle, height, and width adjustment

- **Angle:** rotate the screw as picture to adjust the most comfortable armrest angle. (Figure 15)
- **Width:** Loosen the thumbscrews as picture to adjust the width, tighten again to lock at a desired position. (Figure 16)
- **Height:** Loosen screw, adjust to height hole, then tighten. (Figure 17)
- Pull the armrest up when getting on or off the scooter.

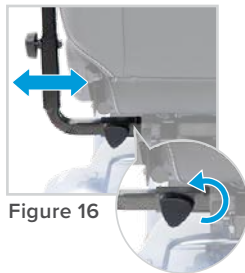

WARNING! When driving the scooter, set the seat at foremost position to prevent tip over. **DO NOT** hang heavy goods on the armrests.

8.3 FREE-WHEELING (N-D LEVER)

- When lever is in Neutral (N) position, scooter can be moved manually without power. (Figure 18-2)
- When lever is in Drive (D) position, scooter can be driven. Normal position is D. (Figure 18-1)



Figure 18-1



Figure 18-2



WARNING! When Freewheel operation is only recommended on flat surfaces. Never leave your scooter on gradient with its motors disengaged.



WARNING! When adjusting N-D lever, do not sit on the scooter.



WARNING! It's not able to drive the scooter when the lever is in Neutral. You must turn off the scooter first and switch to D lever, then turn on and drive scooter.

8.4 TIE-DOWN HOOKS

- To ensure safety during the transportation. There are four fixed hooks for fixing scooter on other vehicles. (Figure 19)
- Make sure the scooter's N-D lever is in D position when transporting. (Figure 18-1)
- Do not sit on the scooter during transportation.

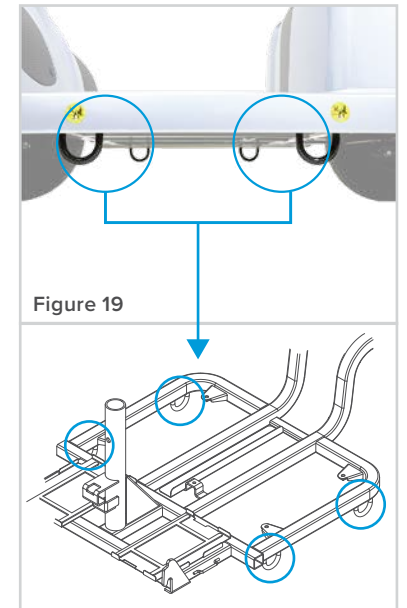

Figure 19

8.5 DISASSEMBLING YOUR SCOOTER

Disassembling seat: By lifting lever to remove seat upwards. (Figure 20)



Disassembling front basket: Lift the front basket upwards. (Figure 21)



Rear Compartment cover: Open the compartment cover upwards according to the steps.

1. Shift the gear to the “N” position.
2. Remove the Rear Shroud (A) gently which is held by Velcro. (Figure 22)
3. Remove the rear lighting wiring from the fixing hooks (B) on both sides. (Figure 23)
4. Carefully lift and remove the Rear Compartment Cover (C), making sure not to pull or strain the rear wiring. (Figure 24)

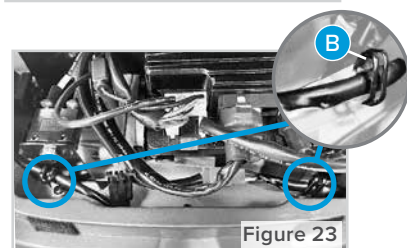
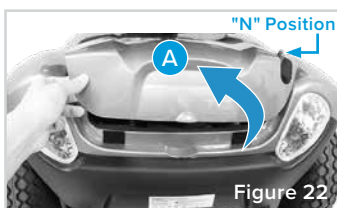

WARNING

Do not turn on the scooter during disassembly or assembly. Keep the scooter in the “N” position to make disassembly easier and prevent parts from getting stuck.



WARNING

Do not modify or change the scooter with non-authorized parts or accessories.

8.6 DISASSEMBLING BATTERIES

Release the battery velcro straps and disconnect the battery connectors to remove the batteries. (Figure 25~30)



Figure 25



Figure 26

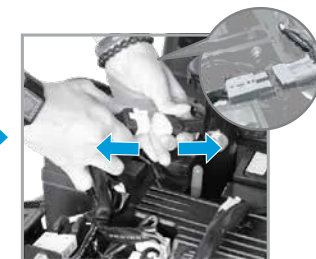

Figure 27

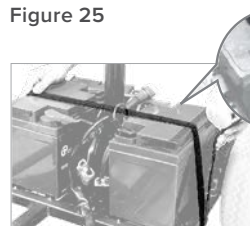

Figure 28



Figure 29

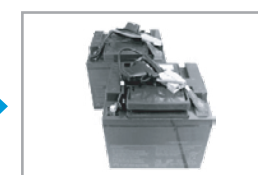

Figure 30



WARNING

Batteries are heavy, be careful when removing the batteries.



WARNING

Do not connect battery terminal [+] [-] with any metals to avoid danger.



WARNING

Connect the red terminal to red, blue terminal to blue.



WARNING

When replacing the batteries remove the screws and connectors in sequence and tighten each component back.



WARNING

Maintenance & repair must only be carried out by a competent engineer or authorised dealer.

9. BATTERY & CHARGING THE BATTERY

9.1 BATTERY GAUGE

There is a meter shows batteries capacity status.

When battery gauge light trends to F, it indicates sufficient power capacity.

When battery gauge light trends to E, it indicates insufficient power capacity.



WARNING! Each country may supply different charger. The charging procedure may be different from below. If you require more details, please contact your authorised dealer.

9.2 OPERATING THE CHARGER

Batteries must be charged before using the scooter for the first time and should be recharged after each day use. You will need the scooter and the battery charger.



WARNING! Each country may supply different charger. The charging procedure may be different from below. If you require more details, please contact your authorised dealer.



WARNING! Be sure the scooter key is in the OFF position.



WARNING! Do not use extension cord to connect the charger.



WARNING! Do not use other brand charger to charge the scooter.

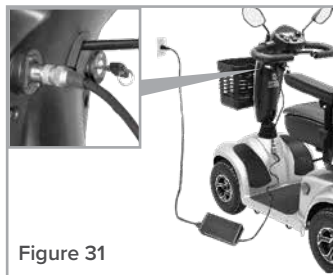

Figure 31

1. Insert battery charger cord into the charger connector on the charger output. Refer to above figure for correct position
2. Plug the other end of the battery charger cable into a standard electrical outlet.
3. Turn the power on. Normally, The LED (Power) Light will turn on when electric current passes.

4. Charging starts. During charging, LED (Charge) will indicate orange light, when it turns to green light, that means well-charged.

5. LED indication

- LED (POWER) - GREEN LIGHT ON : Power On.
- LED (CHARGE) - ORANGE LIGHT ON : Charging
GREEN LIGHT ON : Fully Charged

6. Charger Trouble Shooting

(A) If LED (POWER) light is off

- Check the input voltage (115V/230V) is the same as you adjust.
- If light is still off, please check and repair the battery charger.

(B) If LED (CHARGE) light is off

- Check to see clips connection is correct.
- If the battery is fully charged, the LED (CHARGE) light will be off.
- If light is still off, the battery may be defective.

(C) If ORANGE light can turn to GREEN

- The battery can not be charged. Please check and recover it.

(D) If ORANGE light turns to GREEN immediately

- Check to see the battery is fully charged, if not, the battery may be defective. Check and recover it.



The time needed to recharge will vary depending on the depletion of the batteries. Charging for longer than necessary will harm the batteries. They can not be overcharged.

9.3 INFORMATION FOR BATTERY & CHARGER

Battery

- Only be used for 12V lead-acid battery, not used for other type of battery or other voltage.
- Do not turn the key on while scooter is in charging.
- Charge the batteries after each trip. Only use the battery charger (under 8Amps) supplied with your scooter.

- If the scooter is not used for some time batteries must be recharged once every three months at least. Make sure that batteries are fully charged, and on returning, charge them again before using scooter.
- Batteries will only give maximum performance after scooter has been used. And batteries have been recharged up to 10 times.
- Do not switch off, unplug or interrupt the recharge cycle until the charging cycle has completed. (charger indicator turns green)
- The minimum time needed to recharge will vary up to 15hrs which depends on the depletion of the batteries. Excessive or short period charging will be detrimental to battery life.
- Please charge the scooter in 0°C ~ 40°C, out of this range might affect the performance of the charger and battery.
- For longest life, your batteries should be recharged regularly. Please recharge the batteries before they run down to 20%.

Charger

Do not leave charger plugged into your scooter with charger switched off as this may discharge your batteries.

- Inspect the battery charger before each use, make sure connectors are dry and clean. Do not attempt to use an extension cord to plug in your battery charger.
- Be aware that the battery charger case may become hot during charging. Please avoid skin contact.



WARNING! The battery charger is equipped with cooling fan. If the fan does not appear to be working correctly, please turn off the charger immediately as it may be overheated. Please contact Aidacare.



WARNING! Use the battery charger in a well-ventilated area. Do not smoke as explosive gases may be generated while charging the batteries.



WARNING! Any battery faults due to unauthorised maintenance, dismantle, misuse or accidental damage is not covered by the manufacturer's warranty.

10. CARE, MAINTENANCE & CUSTOMISATION

10.1 DAILY CHECK

Please always check your scooter before you start your every journey.

Check point	Inspection	Ref.	What to do if the inspection is failed
N-D lever	Check for correct function	P.24	Contact Aidacare
Horn	Check for correct function	P.22	Contact Aidacare
Throttles	Pull the wigwag to test the scooter movement	P.22	Contact Aidacare
Electromechanical brake and Emergency hand brake	Pull the wigwag a little bit and release it to test if brake works. If your scooter comes with emergency handbrake, please check it as well.	P.23	Contact Aidacare
Battery Gauge	Check if the battery gauge is displayed and whether it is at low power.	P.28	Contact Aidacare if battery gauge is not working. Recharge the battery immediately if low
Rear mirror (s)	Check if the parts are clean and firmly tighten to the scooter and do not wobble.	P.18	Clean up the dirt by damp cloth. Tighten the screw or clamping stem that holds the mirror(s)
Lighting	Check if all lights, such as head lights, rear lights, and turn signal are functioning correctly.	P.22	Contact Aidacare

10.2 WEEKLY CHECK

Check point	Inspection	Ref.	What to do if the inspection is failed
Speed Dial Knob	Check for correct function	P.21	Contact Aidacare
Armrests	Check if the parts are clean and firmly tighten to the scooter and do not wobble. Tighten the screw knob that holds the armrest.	P.24	Contact Aidacare
Wheels/Tyres	Inflate the tyre to the correct pressure and check that 1. Drive wheels rotate without wobbling. 2. Tyre tread depth is not less than 0.5mm. 3. No foreign objects in tyres.	P.34	Contact Aidacare
Motor	Check for correct function	Observe while driving	Contact Aidacare
Battery Charger	Check if the charger is functioning correctly and the batteries are charged.	P.28	Contact Aidacare

10.3 MONTHLY CHECK

Check point	Inspection	Ref.	What to do if the inspection is failed
Seat / Upholstery	Check for movement and if it's worn	P.23	Contact Aidacare
Electronics	Check if all the battery cables and connectors are firmly tighten to the scooter	P.27	Contact Aidacare

10.4 CLEANING YOUR SCOOTER

- Do not use any abrasive or scouring liquids for cleaning. Only use a damp cloth and gentle detergent.
- Do not use hose pipe or splash water directly onto the scooter as this may cause damage to electronics.

10.5 MAINTENANCE

- User should inspect the scooter regularly to keep scooter in good running order.
- Check if the electrical cable connectors are fully connected.
- All maintenance and repair of scooter should be done by an authorised dealer.

Seat Upholstery

Only use damp cloth and a little soap to wipe the seat. Do not use abrasive cleaners as this will damage the seat.

Storage

- Please store the scooter in a dry location. If store the scooter in long time, please disconnect the battery terminals.
- Do not store your scooter where it will be exposed to a source of direct heat, damp, oil, acid, alkaline, or where Ozone could be possibly generated. All of the above will minimise scooter / tyre cycle and shorten its lifetime.

Tyre

User should inspect the tyres frequently for damage, the presence of foreign bodies, unusual wear and sufficient tread depth. If replacement tyres are needed, please contact the nearest dealer.

The following areas require periodic inspection:

- Tyre pressure between 30-35psi
- Tread depth drops below 0.5mm

Recommended range of storage,

Temperature : -30°C ~ +50°C,

Humidity : 25% ~ 85%

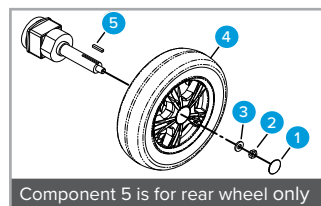

Follow these easy steps to replace the tyre:

1. Turn off the scooter and remove the key. Make sure the lever is in D position before you lift the scooter.
2. Use an ratchet and socket to remove the drive wheel screw from the centre hub of the wheel. Pull the wheel off of the axle.
3. Separate the tyre from the rim.
4. Remove the old tyre and replace it with a new tyre.
5. Slide the wheel back onto the shaft.
6. Install the drive wheel nut into the centre hub and verify the key is lined up with axle and wheel, then tighten to secure it in place. (Torque 300±30kgf-cm)

All maintenance and repair of scooter should be done by an authorised dealer.

11. TROUBLE SHOOTING

Here are some suggestions about solving problems you may have with your scooter. There is a self-diagnostic warning light on the control panel. To check the self-diagnostic warning light, turn on the key and count the number of blinks on the warning light.

11.1 SCOOTER WON'T MOVE WHEN KEY IS TURNED ON

Check point	Solution
Check if the power is off	Turn the power on.
Check if the N-D lever is in Neutral position	Switch to D (drive) position. Turn off the power and turn on again.
Check if the battery power is enough. (Battery gauge is under 25%)	Recharge the battery and then retest.
Check if the charger power cord is still plugged in scooter	Unplug the charger power cord.

11.2 ERROR CODE

Flash	Description	Initial check points
1	Battery Low	The batteries are running low. • Recharge the batteries.
2	Low Battery Fault	The batteries have run out of charge. • Recharge the batteries. • Check the battery and associated connections and wiring.
3	High Battery Fault	Battery voltage is too high. This may occur if overcharged and/or traveling down a long slope. • If traveling down a slope, reduce your speed to minimise the amount of regenerative charging.
4	Current limit time-out or controller overheat	The motor has been exceeding its maximum current rating for too long. • The scooter may have stalled. Turn the controller off, leave for a few minutes and turn back on again. • The motor may be faulty. Check the motor and associated connections and wiring.
5	Park Brake	Either a park brake release switch is active or the park brake is faulty. • Check the park brake and associated connections and wiring. • Ensure any associated switches are in their correct positions.
6	Drive Inhibit	Either a stop function is active or charger inhibits or OONAPU condition has occurred. • Release the stop condition (seat raised etc.) • Disconnect the battery charger. • Ensure the throttle is in Neutral when turning the controller on. • The throttle may require re-calibration.
7	Speed Pot	The throttle, speed limit pot. SRW or their associated wiring maybe faulty. • Check the throttle and speed pot and associated connections and wiring.
8	Motor Voltage	The motor or its associated wiring is faulty. • Check the motor and associated connections and wiring.

Flash	Description	Initial check points
9	Other Error	The controller may have an internal fault. • Check all connections and wiring.

11.3 OTHER PROBLEMS

- **Tyre:** Low tyre pressure: pump up tyres to 30~35 psi.
- **Charger:** During charging, light on charger doesn't change to green. Please refer to section 9.

12. WARRANTY

7 YEAR LIMITED WARRANTY
Frame

5 YEAR LIMITED WARRANTY
Motors, Axles & Brakes

1 YEAR LIMITED WARRANTY
Electronics

6 MONTH LIMITED WARRANTY
Battery

The Aspire Sierra scooter comes with a 7-year limited warranty on frame, a 5-year limited warranty on motors, axles, and brakes, a 1 year limited warranty on components and 6 month on the battery. Please keep purchase invoice as proof of warranty commencement. This product carries a warranty that varies by component part and is against manufacturer defect only, it does not cover wear and tear through use. For further information contact Aidacare.

13. COMPLIANCE

This range of scooters are manufactured in ISO compliant production facilities in Taiwan, adhering to strict quality control standards.

Aspire scooters are manufactured and independently tested to meet relevant market compliance standards.

Labels on the scooter address compliance requirements, and users should familiarise themselves with these before use.

14. RECYCLING INFORMATION

This product is fitted with electronic components and should not be mixed with general household waste. Please follow the diagram below to identify the materials on the product. Old batteries and electronics are to be taken to your nearest recycling centre for recycling or contact your retailer.



Lead Acid Battery

Waste of Electrical and Electronic Equipment (WEEE)

Metal Frame, Plastic Body Parts, and Nylon Upholstery

15. MANUFACTURER, IMPORTER & EU REPRESENTATIVE

If you have any questions, you can contact:



Manufacturer:

Aidacare Pty Ltd ABN 40 134 398 833

Building 3A, 1 Moorebank Avenue,
Moorebank NSW 2170 Australia

1300 133 120 | product@aidacare.com.au



EU Representative:

European Heathcare & Device Solutions (Ireland)Ltd.

Stratton House, Bishopstown Road,
Cork T12 Y9TC Ireland

info@europeandevicesolutions.eu



Importer:

Aidacare Ltd Registration 13785408

Arcadia House, Maritime Walk, Ocean Village,
Southampton SO14 3TL United Kingdom

01622 541235 | info@aidacare.co.uk

The manufacturer reserves the right to alter, without notice, any weights, measurements or other technical data shown in this manual. All figures, measurements and capacities shown in this manual are approximate and do not constitute specifications.

AIDACARE PTY LTD

Building 3A, 1 Moorebank Avenue,
Moorebank NSW 2170
Australia

1300 133 120 | aidacare.com.au

MADE IN TAIWAN

050326

