

# MobilityHQ

## SHOWER STOOL

USER MANUAL



PRECAUTIONS & MAINTENANCE

- Before use, please read all instructions carefully and ensure the bench is assembled correctly
- Inspect all parts for shipping damage before assembly
- Do not use the bench if any parts are damaged or missing
- Ensure the height adjustment spring pins are fully protruding through the same corresponding hole on each leg extension. This ensures the legs are securely locked and the bench remains level
- Tighten all thumb screws securely before use
- Check the rubber tips on each leg for wear, tearing, or signs of damage
- Replace any damaged or missing tips immediately. All four legs must be in contact with the floor at all times to maintain stability. When used in a bath or shower, ensure that the rubber tips are not pressed against the sides of the bath or walls
- Do not stand on the bench
- Before each use, check for overall stability. Ensure all springs are properly engaged and the legs are adjusted to the same height. Place the shower bench on a level surface
- Periodically recheck all screws and connections to ensure they remain secure
- Max user weight must NOT exceed 136kg at any time

INTENDED USE

This shower bench is designed to assist users who need support while bathing. It is particularly useful for:

- Older adults
- People with arthritis or back problems
- Anyone who finds it difficult to stand for long periods

The seat is moulded for comfort and safety, with a textured surface and drain holes that allow water to drain freely. This helps reduce the risk of slipping or falling during showering or bathing.

MAINTENANCE

- Ensure shower chair is stored in a dry area with air flow or dried after each use
- Clean the bench regularly using a damp cloth and mild detergent
- Avoid abrasive cleaners or bleach, which may damage the surface
- Dry with a soft cloth after cleaning
- Remove any hair or debris from around the leg joints or rubber tips.
- Periodically inspect all parts:
  - Check that all screws are tight
  - Inspect rubber tips for wear
  - Ensure spring pins are functioning

PARTS LIST

- A 1 x Moulded seat
- B 2 x Leg frame assemblies (marked '1' and '2')
- C 4 x Adjustable legs with rubber tips
- D 5 x Washers
- E 5 x Thumb screws

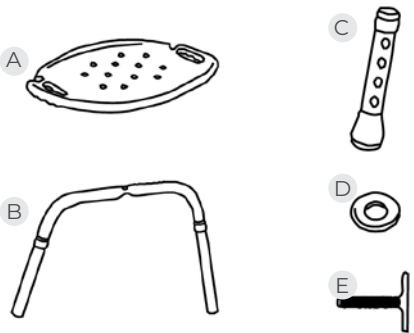

ASSEMBLY INSTRUCTIONS

- 1 Remove the contents from the packaging.
- 2 Turn the seat upside-down. Insert the leg frame marked '1' into the groove beneath the seat. Place leg frame '2' over leg frame '1' and secure both using a thumb screw through the centre hole.
- 4 Attach the adjustable legs. Insert each leg into the leg frames by depressing the push pin, sliding the leg into place, and adjusting to the desired height. Ensure all four legs are set to the same height.

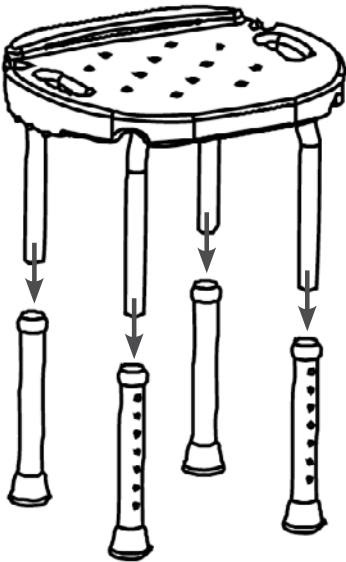
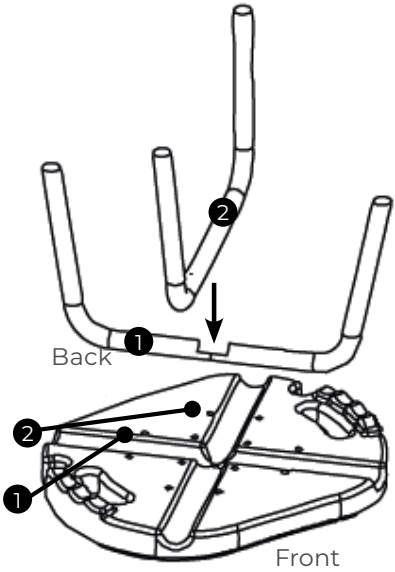

- 3 Secure the leg frames. Insert the remaining four thumb screws into the outer holes and tighten them securely.
- 5 The shower bench is now ready for use.

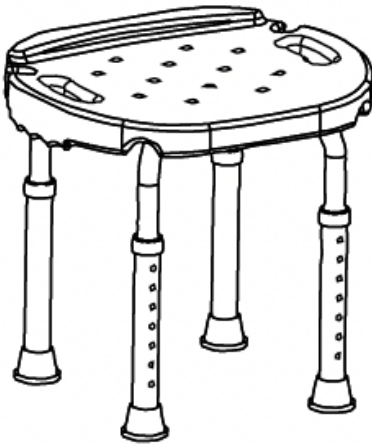
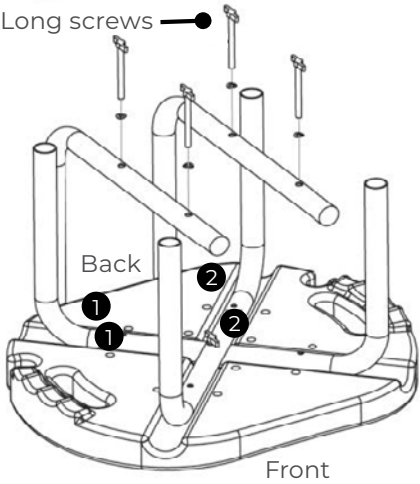

**AIDACARE PTY LTD**

Building 3A, 1 Moorebank Avenue  
Moorebank NSW 2170 Australia

**1300 133 120** | [aidacare.com.au](https://aidacare.com.au)

MUM03.3 160425

**MobilityHQ**